



SHEET 2

SHEET 3

**FLAGSTONE
STAGE 5F**
For
**PEET FLAGSTONE
CITY PTY LTD**

IMPORTANT NOTES:
This Plan has been prepared for PEET FLAGSTONE CITY PTY LTD to Logan City standards, for the purpose of recording the As Constructed details of a new service constructed under a specific Council Approval and should not be used for any other purpose.

No report is made on any other services, nor any services that may exist before or be constructed after, the time of survey, or constructed under any other approval.

The property boundaries, easements and lot numbers shown hereon may be proposed only and subject to registration by the Department of Natural Resources. All property information should be determined from the registered Survey Plans.

All dimensions should be verified and confirmed against the latest information prior to commencement by any person using this plan for building purposes.

Veris Australia Pty Ltd accepts no responsibility for any changes made to construction or otherwise, after the date of this plan. Any discrepancies should be clarified in writing with the relevant Authority prior to commencement of the work.

Copyright © Veris Australia Pty Ltd, May 2024.

THESE DESIGNS AND DRAWINGS ARE COPYRIGHT AND ARE NOT TO BE USED OR REPRODUCED WITHOUT THE WRITTEN PERMISSION OF VERIS

Data Sources	30109-LC-Master(D0) F594 2014.dwg		
Cadastral Boundaries			
As-on survey	Veris		
Engineering Design	COLLIERS		
F Progress Plot	16.09.2024	JMc	
E Progress Plot	10.09.2024	JMc	
D Progress Plot	23.08.2024	JMc	
C Progress Plot	12.07.2024	JMc	
B Progress Plot	29.05.2024	JMc	
A Progress Plot	02.05.2024	JMc	
Issue	Revisions	Date	Drawn

Local Authority: LCC
 Horizontal Meridian: MGA
 Vertical Level Datum: AHD D
 Level Origin: PM107142(RL39.078)
 Scale: 1:750 @ A1
 Surveyed: HA
 Designed: COLLIERS
 Drawn: JMc
 Checked: JMc
 Plot Date: 16 Sep, 2024
 Computer File Ref: 430109-15061-AS01 F LOCAL.dwg

AS-CONSTRUCTED
SEWER
SHEET 1 OF 3



veris

BRISBANE (07) 3666 4700 WHITSUNDAYS (07) 4945 6600
 MACKAY (07) 4957 9100 CAIRNS (07) 4232 9400

veris.com.au
 ACN 615 735 727
 Veris Australia Pty Ltd

Drawing No Issue
430109-15061-AS01 F

Consulting Engineer's Certification.
 I, **Dan Collins**, hereby certify that the As Constructed information shown on this plan is a true and correct record of the sizes, types, materials, classes etc., and it corresponds with the relevant approved Engineering Drawings.

Signed RPEQ No **18631** Dated **25/09/2024**

Registered Surveyor's Certification.
 We, **VERIS AUSTRALIA P/L**, hereby certify that the horizontal and vertical locations, and dimensions shown on this plan are a true and correct record of the As Constructed information.

Signed Cadastral Surveyor & Delegate Reg. No **6448**
 Dated **23/09/2024**

Stage 5Piii

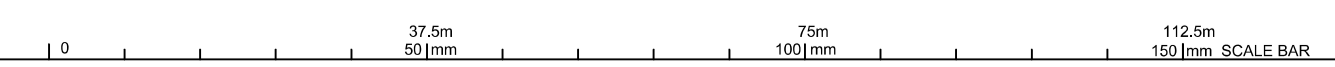



Consulting Engineer's Certification.

I, **Dan Collins**..... hereby certify that the As Constructed information shown on this plan is a true and correct record of the sizes, types, materials, classes etc., and it corresponds with the relevant approved Engineering Drawings.

Signed..... RPEQ No 18631 Dated 25/09/2024

Registered Surveyor's Certification.

We, **VERIS AUSTRALIA P/L**..... hereby certify that the horizontal and vertical locations, and dimensions shown on this plan are a true and correct record of the As Constructed information.

Signed..... Cadastral Surveyor Reg. No 6448
 & Delegate
 Dated 23/09/2024

FLAGSTONE STAGE 5F
 For
PEET FLAGSTONE CITY PTY LTD

IMPORTANT NOTES:
 This Plan has been prepared for PEET FLAGSTONE CITY PTY LTD to Logan City standards, for the purpose of recording the As Constructed details of a new service constructed under a specific Council Approval and should not be used for any other purpose.

No report is made on any other services, nor any services that may exist before or be constructed after, the time of survey, or constructed under any other approval.

The property boundaries, easements and lot numbers shown hereon may be proposed only and subject to registration by the Department of Natural Resources. All property information should be determined from the registered Survey Plans.

All dimensions should be verified and confirmed against the latest information prior to commencement by any person using this plan for building purposes.

Veris Australia Pty Ltd accepts no responsibility for any changes made to construction or otherwise, after the date of this plan. Any discrepancies should be clarified in writing with the relevant Authority prior to commencement of the work.

Copyright © Veris Australia Pty Ltd, May 2024.

THESE DESIGNS AND DRAWINGS ARE COPYRIGHT AND ARE NOT TO BE USED OR REPRODUCED WITHOUT THE WRITTEN PERMISSION OF VERIS

Data Sources 30109-LC-Master(DS) F504 2014.dwg
 Cadastral Boundaries
 As-on survey Veris
 Engineering Design COLLIER'S

Issue	Revisions	Date	Drawn
F	Progress Plot	16.09.2024	JMc
E	Progress Plot	10.09.2024	JMc
D	Progress Plot	23.08.2024	JMc
C	Progress Plot	12.07.2024	JMc
B	Progress Plot	22.05.2024	JMc
A	Progress Plot	02.05.2024	JMc

Local Authority: LCC
 Horizontal Meridian: MGA
 Vertical Level Datum: AHD D
 Level Origin: PM107142(RL39.078)
 Scale: 1:250 @ A1
 Surveyed: HA
 Designed: COLLIER'S
 Drawn: JMc
 Checked: JMc
 Plot Date: 16 Sep. 2024
 Computer File Ref: 430109-15061-AS01 F LOCAL.dwg

AS-CONSTRUCTED SEWER

SHEET 2 OF 3

veris

BRISBANE 071 3666 4700 WHITSUNDAYS 071 4945 6600
 MACKAY 071 4957 9300 CAIRNS 071 4232 9400

veris.com.au
 ACN 615 735 727
 Veris Australia Pty Ltd

Drawing No 430109-15061-AS01 F Issue

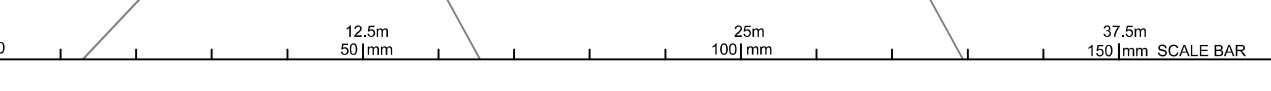



FLAGSTONE STAGE 5F
For
PEET FLAGSTONE CITY PTY LTD

IMPORTANT NOTES:
This Plan has been prepared for PEET FLAGSTONE CITY PTY LTD to Logan City standards, for the purpose of recording the As Constructed details of a new service constructed under a specific Council Approval and should not be used for any other purpose.
No report is made on any other services, nor any services that may exist before or be constructed after, the time of survey, or constructed under any other approval.
The property boundaries, assessments and lot numbers shown hereon may be proposed only and subject to registration by the Department of Natural Resources. All property information should be determined from the registered Survey Plans.
All dimensions should be verified and confirmed against the latest information prior to commencement by any person using this plan for building purposes.
Veris Australia Pty Ltd accepts no responsibility for any changes made to construction or otherwise, after the date of this plan. Any discrepancies should be clarified in writing with the relevant Authority prior to commencement of the work.

Copyright © Veris Australia Pty Ltd, May 2024.
THESE DESIGNS AND DRAWINGS ARE COPYRIGHT AND ARE NOT TO BE USED OR REPRODUCED WITHOUT THE WRITTEN PERMISSION OF VERIS

Data Sources: 30109-LC-Master(DS) F594 2014.dwg
Cadastral Boundaries
As-on survey
Engineering Design: Veris COLLIERS

Issue	Revisions	Date	Drawn
F	Progress Plot	16.09.2024	JMc
E	Progress Plot	10.09.2024	JMc
D	Progress Plot	23.08.2024	JMc
C	Progress Plot	12.07.2024	JMc
B	Progress Plot	29.05.2024	JMc
A	Progress Plot	02.05.2024	JMc

Local Authority: LCC
Horizontal Meridian: MGA
Vertical Level Datum: AHD D
Level Origin: PM107142(RL39.078)
Scale: 1:250 @ A1
Surveyed: HA
Designed: COLLIERS
Drawn: JMc
Checked: JMc
Plot Date: 16 Sep, 2024
Computer File Ref: 430109-15061-AS01 F LOCAL.dwg

AS-CONSTRUCTED SEWER
SHEET 3 OF 3

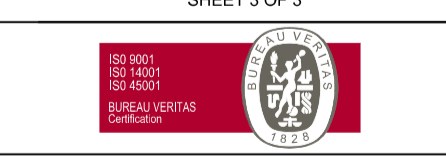

veris
BRISBANE (07) 3666 4700 WHITSUNDAYS (07) 4945 6600
MACKAY (07) 4957 9300 CAIRNS (07) 4232 9400
veris.com.au
ACN 615 735 727
Veris Australia Pty Ltd
Drawing No: 430109-15061-AS01 F Issue

Consulting Engineer's Certification.
I, **Dan Collins**, hereby certify that the As Constructed information shown on this plan is a true and correct record of the sizes, types, materials, classes etc., and it corresponds with the relevant approved Engineering Drawings.
Signed: RPEQ No 18631 Dated: 25/09/2024

Registered Surveyor's Certification.
We, **VERIS AUSTRALIA P/L**, hereby certify that the horizontal and vertical locations, and dimensions shown on this plan are a true and correct record of the As Constructed information.
Signed: Cadastral Surveyor & Delegate Reg. No 6448
Dated: 23/09/2024

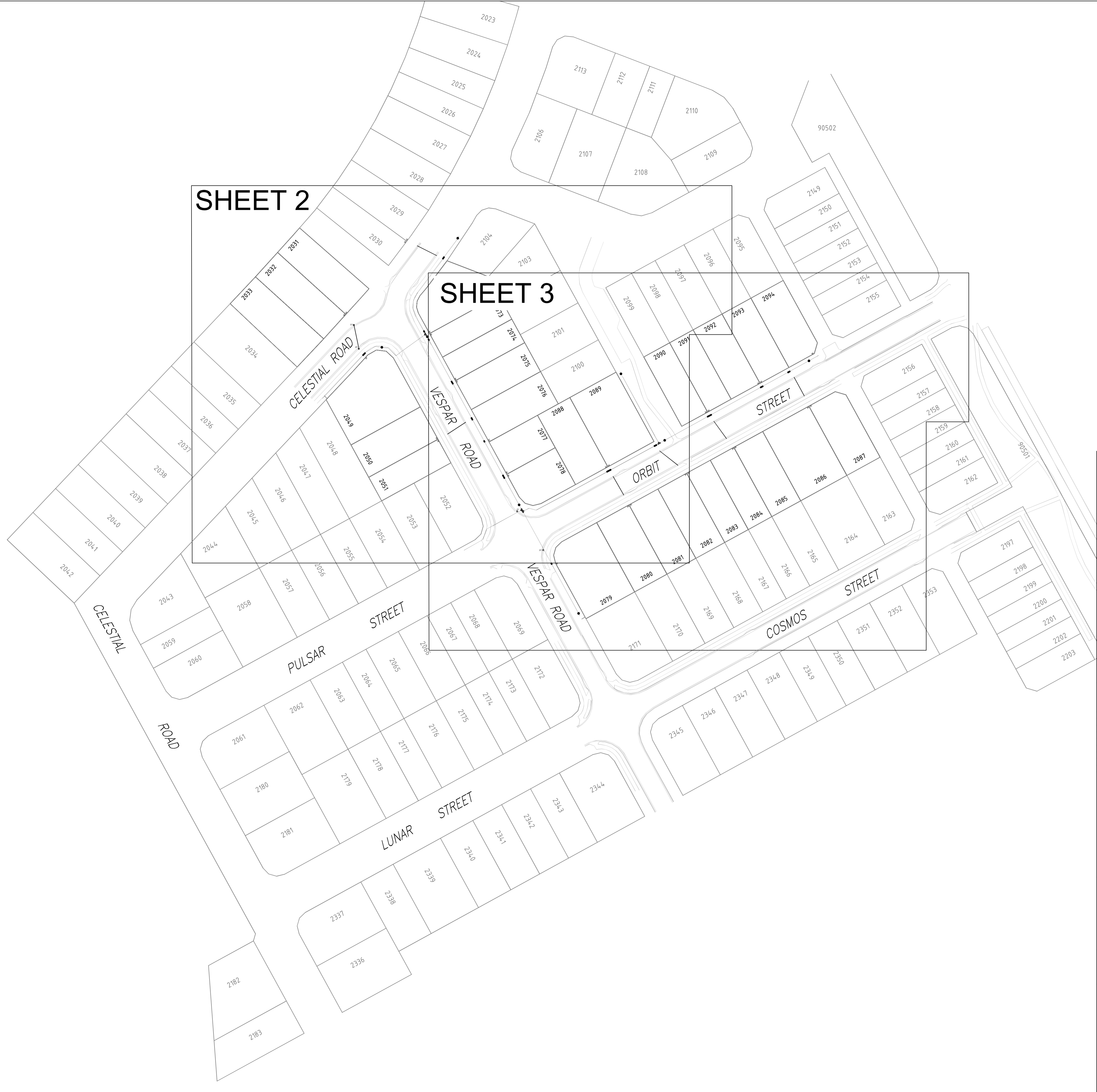

SHEET 2

SHEET 3

**FLAGSTONE
STAGE 5F**
For
**PEET FLAGSTONE
CITY PTY LTD**

IMPORTANT NOTES:
This Plan has been prepared for PEET FLAGSTONE CITY PTY LTD to Logan City standards, for the purpose of recording the As-Constructed details of a new service constructed under a specific Council Approval and should not be used for any other purpose.
No report is made on any other services, nor any services that may exist before or be constructed after, the time of survey, or constructed under any other approval.
The property boundaries, easements and lot numbers shown hereon may be proposed only and subject to registration by the Department of Natural Resources. All property information should be determined from the registered Survey Plans.
All dimensions should be verified and confirmed against the latest information prior to commencement by any person using this plan for building purposes.
Veris Australia Pty Ltd accepts no responsibility for any changes made to construction or otherwise, after the date of this plan. Any discrepancies should be clarified in writing with the relevant Authority prior to commencement of the work.

Copyright © Veris Australia Pty Ltd, May 2024.
THESE DESIGNS AND DRAWINGS ARE COPYRIGHT AND ARE NOT TO BE USED OR REPRODUCED WITHOUT THE WRITTEN PERMISSION OF VERIS

Issue	Revisions	Date	Drawn
C	Progress Plot	10.09.2024	JMc
B	Progress Plot	06.08.2024	JMc
A	Progress Plot	22.05.2024	JMc

Local Authority: LCC
 Horizontal Meridian: MGA
 Vertical Level Datum: AHD D
 Level Origin: PM107142(RL39.078)
 Scale: 1:750 @ A1
 Surveyed: HA
 Designed: COLLIERS
 Drawn: JMc
 Checked: JMc
 Plot Date: 13 Sep, 2024
 Computer File Ref: 430109-15061-AW01 C LOCAL.dwg

**AS-CONSTRUCTED
WATER**
SHEET 1 OF 3



veris
 BRISBANE (07) 3669 4700
 WHITSUNDAYS (07) 4645 9500
 MACKAY (07) 4967 9700
 CAIRNS (07) 4252 9400
 veris.com.au
 ACN 615 735 727
 Veris Australia Pty Ltd

Consulting Engineer's Certification.
 I, **Dan Collins**, hereby certify that the As Constructed information shown on this plan is a true and correct record of the sizes, types, materials, classes etc., and it corresponds with the relevant approved Engineering Drawings.
 Signed: RPEQ No 18631. Dated 25/09/2024

Registered Surveyor's Certification.
 We, **VERIS AUSTRALIA P/L**, hereby certify that the horizontal and vertical locations, and dimensions shown on this plan are a true and correct record of the As Constructed information.
 Signed: Cadastral Surveyor & Delegate Reg. No ..6448.. Dated 23/09/2024

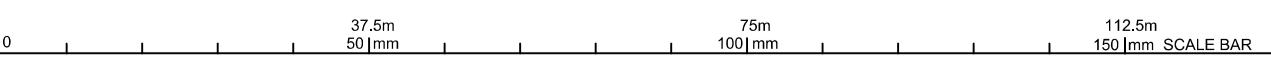



LEGEND

- NEW HYDRANT
- NEW SLUICE VALVE
- NEW TEE
- NEW END CAP
- NEW TAPER
- NEW WATER SERVICE CONDUIT (Ø100 PVC-O PN16)
- WATER SERVICE POINT
- NEW WATER HOUSE CONNECTION (TAPPING BAND)
- NEW WATER MAKER
- ① Ø100 11.25° BEND
- ② Ø100 22.5° BEND
- ③ Ø100 45° BEND
- ④ Ø100 90° BEND
- ⑤ Ø150 11.25° BEND
- ⑥ Ø150 22.5° BEND
- ⑦ Ø150 45° BEND
- ⑧ Ø250 11.25° BEND
- ⑨ Ø250 22.5° BEND
- ⑩ Ø250 45° BEND

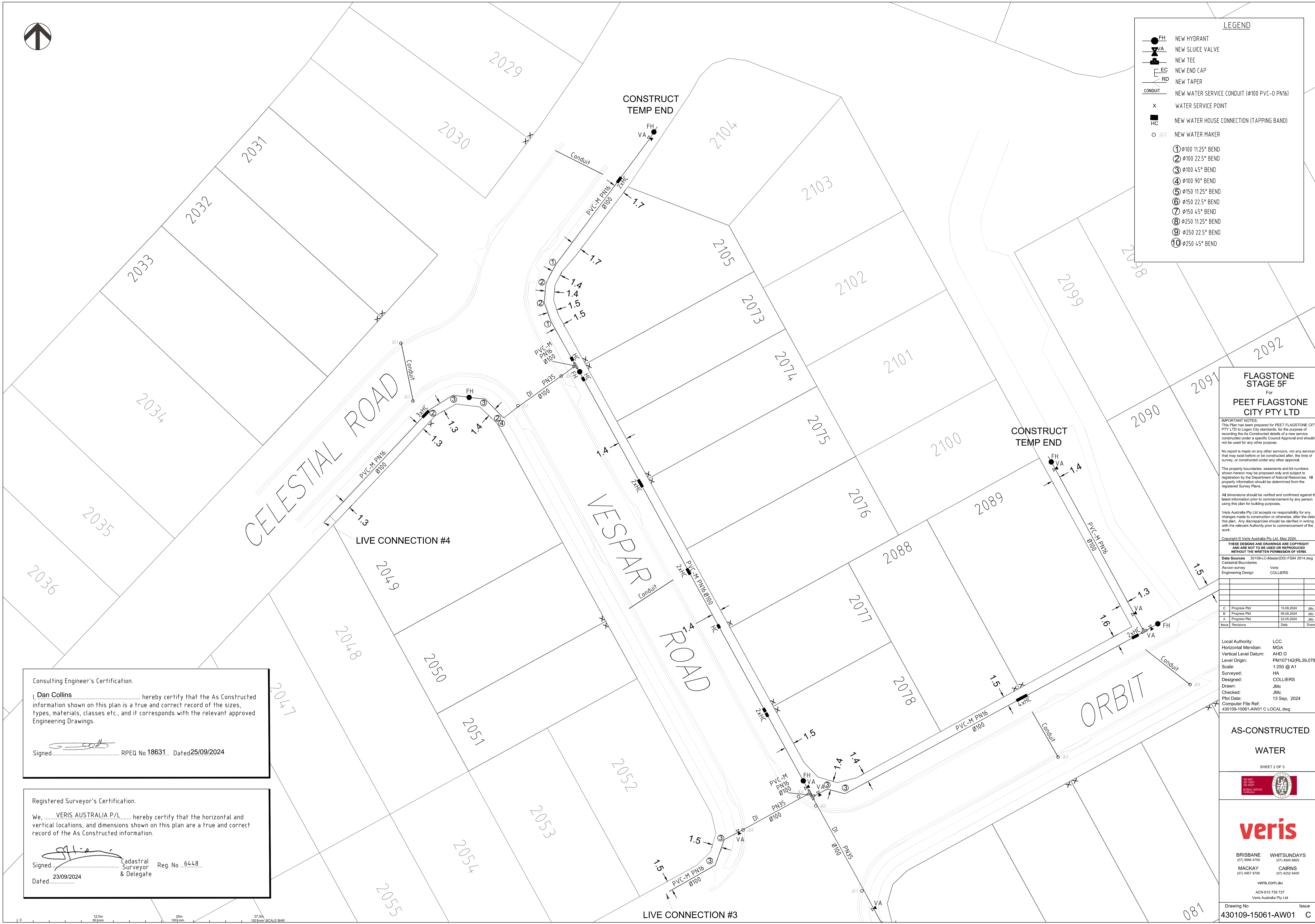

**FLAGSTONE
STAGE 5F**
For
**PEET FLAGSTONE
CITY PTY LTD**

IMPORTANT NOTES:
This Plan has been prepared for PEET FLAGSTONE CITY PTY LTD to Logan City standards, for the purpose of recording the As Constructed details of a new service constructed under a specific Council Approval and should not be used for any other purpose.
No report is made on any other services, nor any services that may exist before or be constructed after, the time of survey, or constructed under any other approval.
The property boundaries, easements and lot numbers shown hereon may be proposed only and subject to registration by the Department of Natural Resources. All property information should be determined from the registered Survey Plans.
All dimensions should be verified and confirmed against the latest information prior to commencement by any person using this plan for building purposes.
Veris Australia Pty Ltd accepts no responsibility for any changes made to construction or otherwise, after the date of this plan. Any discrepancies should be clarified in writing with the relevant Authority prior to commencement of the work.

Copyright © Veris Australia Pty Ltd, May 2024.
THESE DESIGNS AND DRAWINGS ARE COPYRIGHT AND ARE NOT TO BE USED OR REPRODUCED WITHOUT THE WRITTEN PERMISSION OF VERIS

Data Sources	30109-LC-Master(D0) F594 2014.dwg
Cadastral Boundaries	As-on survey
Engineering Design	Veris COLLIERIES

C	Progress Plot	10/09/2024	JMc
B	Progress Plot	08/08/2024	JMc
A	Progress Plot	22/05/2024	JMc
Issue	Revisions	Date	Drawn

Local Authority: LCC
Horizontal Meridian: MGA
Vertical Level Datum: AHD D
Level Origin: PM107142(RL39.078)
Scale: 1:250 @ A1
Surveyed: HA
Designed: COLLIERIES
Drawn: JMc
Checked: JMc
Plot Date: 13 Sep, 2024
Computer File Ref: 430109-15061-AW01 C LOCAL.dwg

**AS-CONSTRUCTED
WATER**

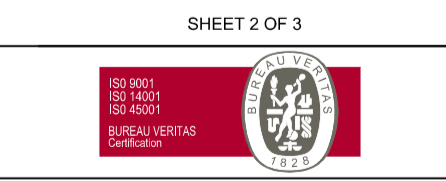

veris

BRISBANE (07) 3666 4700 WHITSUNDAYS (07) 4845 6600
MACKAY (07) 4957 9300 CAIRNS (07) 4252 9400

veris.com.au
ACN 615 735 727
Veris Australia Pty Ltd

Consulting Engineer's Certification.
I, **Dan Collins**, hereby certify that the As Constructed information shown on this plan is a true and correct record of the sizes, types, materials, classes etc., and it corresponds with the relevant approved Engineering Drawings.
Signed: RPEQ No 18631... Dated 25/09/2024

Registered Surveyor's Certification.
We, **VERIS AUSTRALIA P/L**, hereby certify that the horizontal and vertical locations, and dimensions shown on this plan are a true and correct record of the As Constructed information.
Signed: Cadastral Surveyor & Delegate Reg. No. 6448
Dated: 23/09/2024



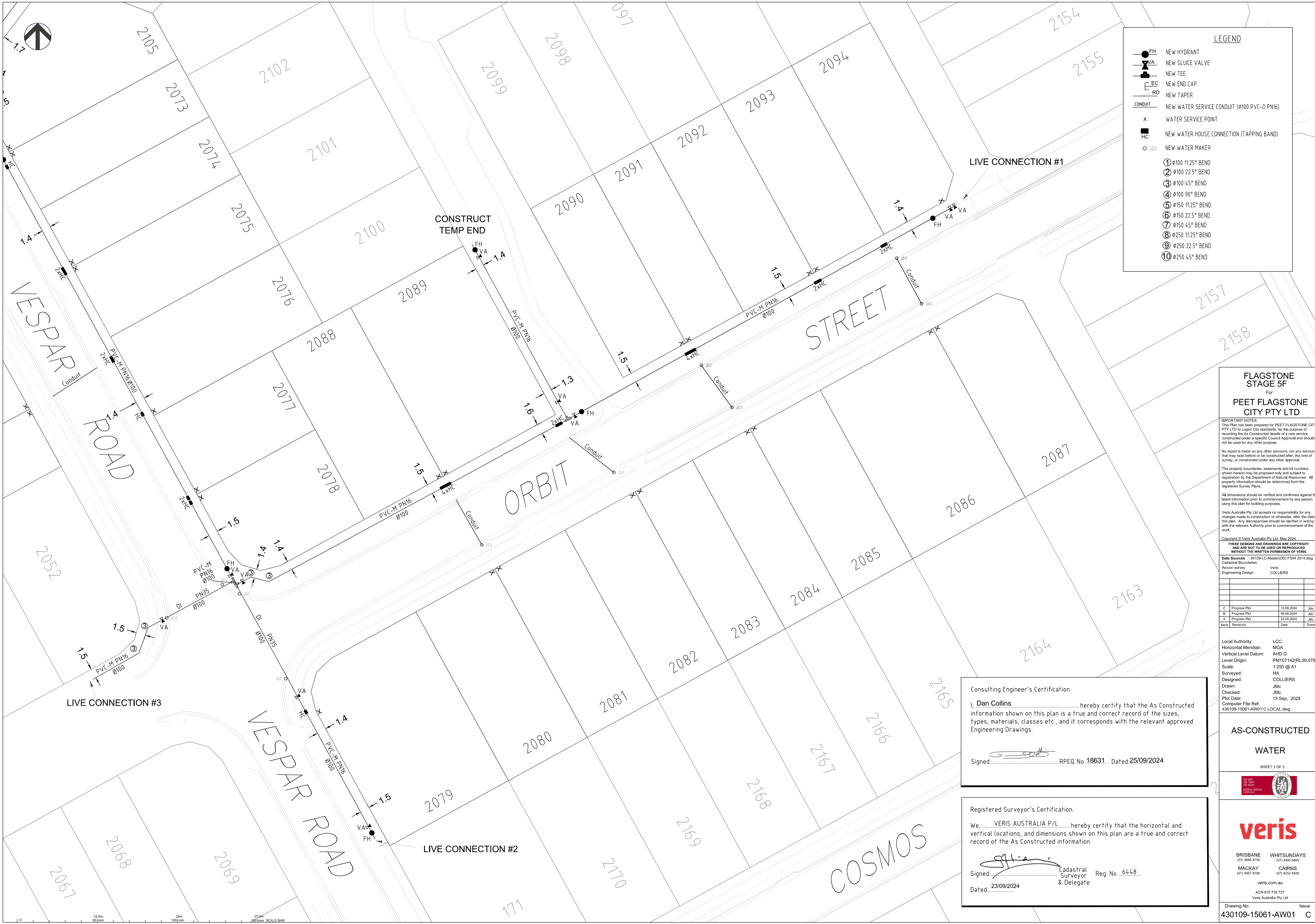

LEGEND

- NEW HYDRANT
- NEW SLUICE VALVE
- NEW TEE
- NEW END CAP
- NEW TAPER
- NEW WATER SERVICE CONDUIT (Ø100 PVC-O PN16)
- WATER SERVICE POINT
- NEW WATER HOUSE CONNECTION (TAPPING BAND)
- NEW WATER MAKER

- ① Ø100 11.25° BEND
- ② Ø100 22.5° BEND
- ③ Ø100 45° BEND
- ④ Ø100 90° BEND
- ⑤ Ø150 11.25° BEND
- ⑥ Ø150 22.5° BEND
- ⑦ Ø150 45° BEND
- ⑧ Ø250 11.25° BEND
- ⑨ Ø250 22.5° BEND
- ⑩ Ø250 45° BEND

**FLAGSTONE
STAGE 5F**
For
**PEET FLAGSTONE
CITY PTY LTD**

IMPORTANT NOTES:
This Plan has been prepared for PEET FLAGSTONE CITY PTY LTD to Logan City standards, for the purpose of recording the As Constructed details of a new service constructed under a specific Council Approval and should not be used for any other purpose.
No report is made on any other services, nor any services that may exist before or be constructed after, the time of survey, or constructed under any other approval.
The property boundaries, easements and lot numbers shown hereon may be proposed only and subject to registration by the Department of Natural Resources. All property information should be determined from the registered Survey Plans.
All dimensions should be verified and confirmed against the latest information prior to commencement by any person using this plan for building purposes.
Veris Australia Pty Ltd accepts no responsibility for any changes made to construction or otherwise, after the date of this plan. Any discrepancies should be clarified in writing with the relevant Authority prior to commencement of the work.

Copyright © Veris Australia Pty Ltd, May 2024.
THESE DESIGNS AND DRAWINGS ARE COPYRIGHT AND ARE NOT TO BE USED OR REPRODUCED WITHOUT THE WRITTEN PERMISSION OF VERIS

Data Sources: 30109-LC-Master(D0) F594 2014.dwg
Cadastral Boundaries: As-on survey
Engineering Design: Veris COLLIERS

Issue	Revisions	Date	Drawn
C	Progress Plot	10/09/2024	JMc
B	Progress Plot	08/08/2024	JMc
A	Progress Plot	22/05/2024	JMc

Local Authority: LCC
Horizontal Meridian: MGA
Vertical Level Datum: AHD D
Level Origin: PM107142(RL39.078)
Scale: 1:250 @ A1
Surveyed: HA
Designed: COLLIERS
Drawn: JMc
Checked: JMc
Plot Date: 13 Sep, 2024
Computer File Ref: 430109-15061-AW01 C LOCAL.dwg

**AS-CONSTRUCTED
WATER**

SHEET 3 OF 3

veris

BRISBANE (07) 3666 4700 WHITSUNDAYS (07) 4945 6600
MACKAY (07) 4957 9300 CAIRNS (07) 4232 9400

veris.com.au
ACN 615 735 727
Veris Australia Pty Ltd

Drawing No: 430109-15061-AW01 Issue: C

Consulting Engineer's Certification.

I, **Dan Collins** hereby certify that the As Constructed information shown on this plan is a true and correct record of the sizes, types, materials, classes etc., and it corresponds with the relevant approved Engineering Drawings.

Signed: RPEQ No. 18631.. Dated 25/09/2024

Registered Surveyor's Certification.

We, **VERIS AUSTRALIA P/L** hereby certify that the horizontal and vertical locations, and dimensions shown on this plan are a true and correct record of the As Constructed information.

Signed: Cadastral Surveyor & Delegate Reg. No. 6448.
Dated: 23/09/2024

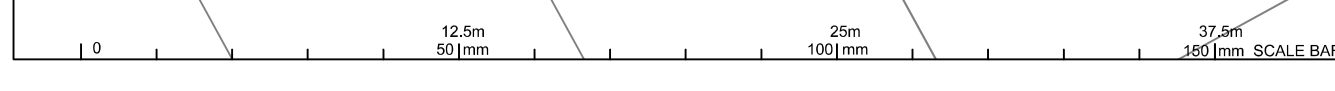



Consulting Engineer's Certification.

I, **Dan Collins** hereby certify that the As Constructed information shown on this plan is a true and correct record of the sizes, types, materials, classes etc., and it corresponds with the relevant approved Engineering Drawings.

Signed..... RPEQ No 18631. Dated 25/09/2024

Registered Surveyor's Certification.

We, **VERIS AUSTRALIA P/L** hereby certify that the horizontal and vertical locations, and dimensions shown on this plan are a true and correct record of the As Constructed information.

Signed..... Cadastral Surveyor & Delegate Reg. No. 6448. Dated 23/09/2024

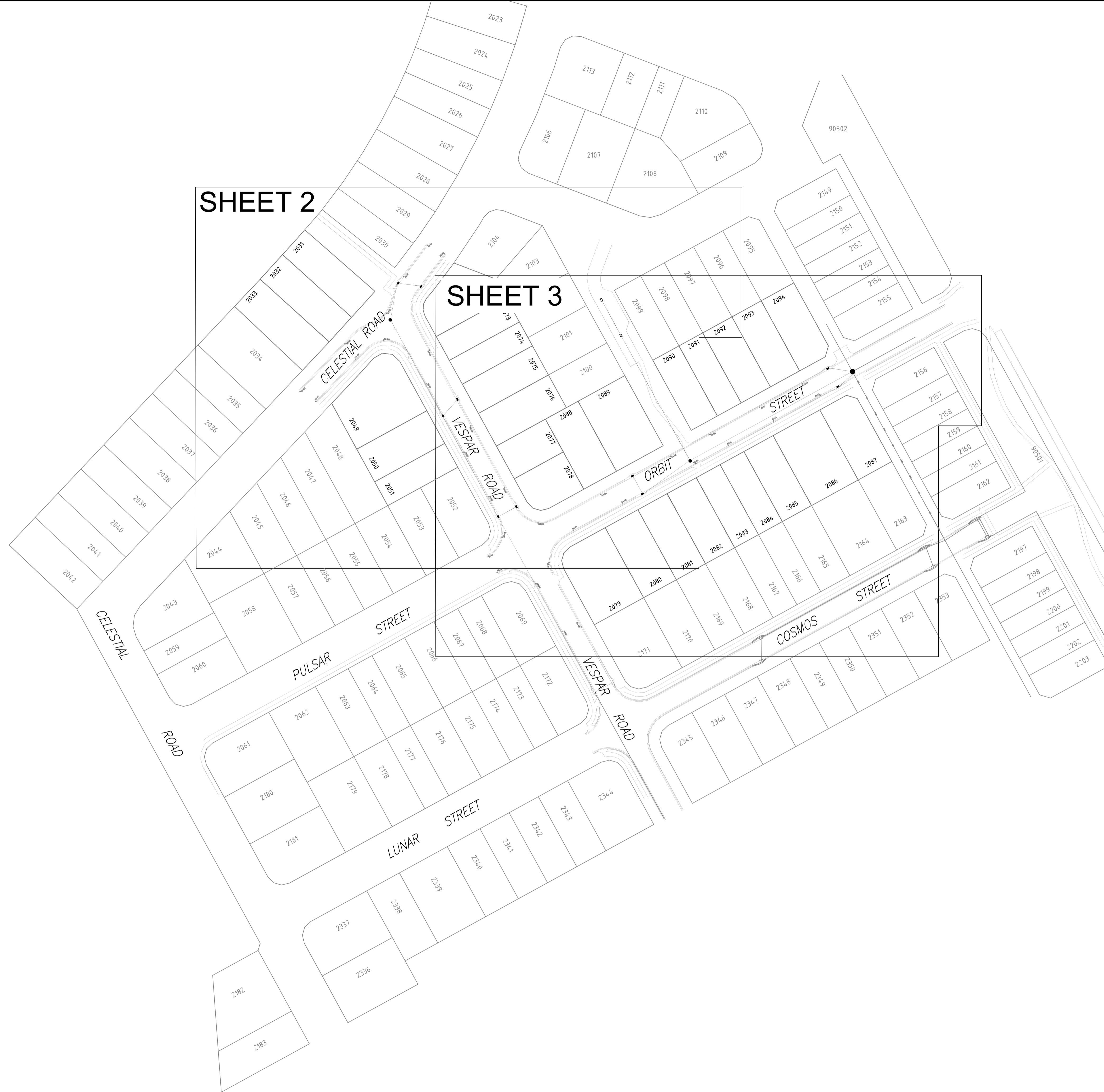

FLAGSTONE STAGE 5F For PEET FLAGSTONE CITY PTY LTD

IMPORTANT NOTES: This Plan has been prepared for PEET FLAGSTONE CITY PTY LTD to Logan City standards, for the purpose of recording the As Constructed details of a new service constructed under a specific Council Approval and should not be used for any other purpose.

No report is made on any other services, nor any services that may exist before or be constructed after, the time of survey, or constructed under any other approval.

The property boundaries, easements and lot numbers shown hereon may be proposed only and subject to registration by the Department of Natural Resources. All property information should be determined from the registered Survey Plans.

All dimensions should be verified and confirmed against the latest information prior to commencement by any person using this plan for building purposes.

Veris Australia Pty Ltd accepts no responsibility for any changes made to construction or otherwise, after the date of this plan. Any discrepancies should be clarified in writing with the relevant Authority prior to commencement of the work.

Copyright © Veris Australia Pty Ltd, August 2024. THESE DESIGNS AND DRAWINGS ARE COPYRIGHT AND ARE NOT TO BE USED OR REPRODUCED WITHOUT THE WRITTEN PERMISSION OF VERIS

Data Sources 30109-LC-Master(DG) F594 2014.dwg
Cadastral Boundaries As-on survey Veris
Engineering Design COLLIERIS

Issue	Revisions	Date	Drawn
C	Progress Plot	06.09.2024	JMc
B	Progress Plot	22.08.2024	JMc
A	Progress Plot	05.08.2024	JMc

Local Authority: LCC
Horizontal Meridian: MGA
Vertical Level Datum: AHD D
Level Origin: PM107142(RL39.078)
Scale: 1:750 @ A1
Surveyed: HA
Designed: COLLIERIS
Drawn: JMc
Checked: JMc
Plot Date: 08 Sep, 2024
Computer File Ref: 430109-15061-ASW01 C LOCAL.dwg

AS-CONSTRUCTED
STORMWATER
SHEET 1 OF 3



veris
BRISBANE (07) 3666 4700 WHITSUNDAYS (07) 4845 6600
MACKAY (07) 4957 8100 CAIRNS (07) 4232 9400
veris.com.au
ACN 615 735 727
Veris Australia Pty Ltd

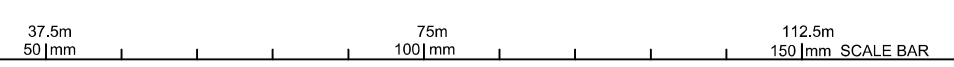



Consulting Engineer's Certification.

I, **Dan Collins**..... hereby certify that the As Constructed information shown on this plan is a true and correct record of the sizes, types, materials, classes etc., and it corresponds with the relevant approved Engineering Drawings.

Signed..... RPEQ No 18631... Dated 25/09/2024

Registered Surveyor's Certification.

We, **VERIS AUSTRALIA P/L**..... hereby certify that the horizontal and vertical locations, and dimensions shown on this plan are a true and correct record of the As Constructed information.

Signed..... **Surveyor**..... Reg. No 6448
 & Delegate
 Dated 23/09/2024

FLAGSTONE STAGE 5F
 For
PEET FLAGSTONE CITY PTY LTD

IMPORTANT NOTES:
 This Plan has been prepared for PEET FLAGSTONE CITY PTY LTD to Logan City standards, for the purpose of recording the As Constructed details of a new service constructed under a specific Council Approval and should not be used for any other purpose.
 No report is made on any other services, nor any services that may exist before or be constructed after, the time of survey, or constructed under any other approval.
 The property boundaries, easements and lot numbers shown hereon may be proposed only and subject to registration by the Department of Natural Resources. All property information should be determined from the registered Survey Plans.
 All dimensions should be verified and confirmed against the latest information prior to commencement by any person using this plan for building purposes.
 Veris Australia Pty Ltd accepts no responsibility for any changes made to construction or otherwise, after the date of this plan. Any discrepancies should be clarified in writing with the relevant Authority prior to commencement of the work.

Copyright © Veris Australia Pty Ltd, August 2024.

THESE DESIGNS AND DRAWINGS ARE COPYRIGHT AND ARE NOT TO BE USED OR REPRODUCED WITHOUT THE WRITTEN PERMISSION OF VERIS

Data Sources 30109-LC-Master(DG) F504 2014.dwg
 Cadastral Boundaries
 As-on survey Veris
 Engineering Design COLLIERIES

Issue	Revisions	Date	Drawn
C	Progress Plot	06.09.2024	JMc
B	Progress Plot	22.08.2024	JMc
A	Progress Plot	05.08.2024	JMc

Local Authority: LCC
 Horizontal Meridian: MGA
 Vertical Level Datum: AHD D
 Level Origin: PM107142(RL39.078)
 Scale: 1:250 @ A1
 Surveyed: HA
 Designed: COLLIERIES
 Drawn: JMc
 Checked: JMc
 Plot Date: 08 Sep, 2024
 Computer File Ref: 430109-15061-ASW01 C LOCAL.dwg

AS-CONSTRUCTED STORMWATER

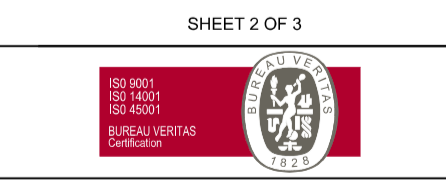

veris

BRISBANE (07) 3666 4700 WHITSUNDAYS (07) 4945 6600
 MACKAY (07) 4957 8100 CAIRNS (07) 4232 9400

veris.com.au
 ACN 615 735 727
 Veris Australia Pty Ltd

Drawing No Issue
430109-15061-ASW01 C

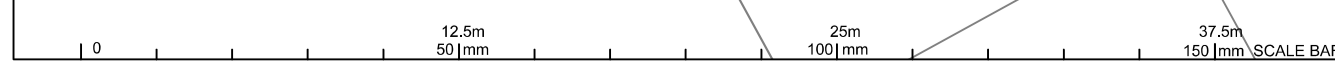

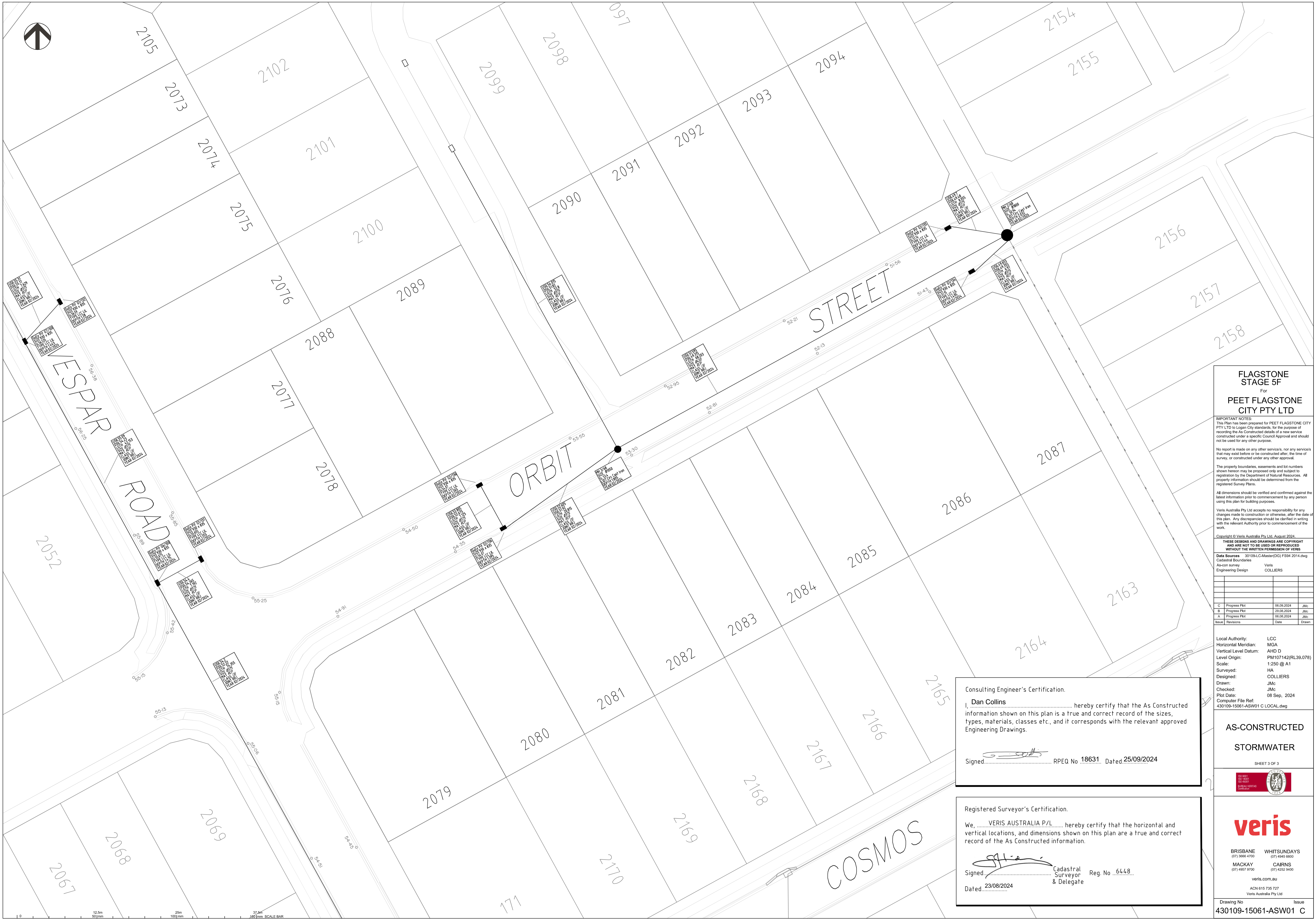

**FLAGSTONE
STAGE 5F**
For
**PEET FLAGSTONE
CITY PTY LTD**

IMPORTANT NOTES:
This Plan has been prepared for PEET FLAGSTONE CITY PTY LTD to Logan City standards, for the purpose of recording the As Constructed details of a new service constructed under a specific Council Approval and should not be used for any other purpose.
No report is made on any other services, nor any services that may exist before or be constructed after, the time of survey, or constructed under any other approval.
The property boundaries, easements and lot numbers shown hereon may be proposed only and subject to registration by the Department of Natural Resources. All property information should be determined from the registered Survey Plans.
All dimensions should be verified and confirmed against the latest information prior to commencement by any person using this plan for building purposes.
Veris Australia Pty Ltd accepts no responsibility for any changes made to construction or otherwise, after the date of this plan. Any discrepancies should be clarified in writing with the relevant Authority prior to commencement of the work.

Copyright © Veris Australia Pty Ltd, August 2024.
THESE DESIGNS AND DRAWINGS ARE COPYRIGHT AND ARE NOT TO BE USED OR REPRODUCED WITHOUT THE WRITTEN PERMISSION OF VERIS

Data Sources: 30109-LC-Master(DG) F594 2014.dwg
Cadastral Boundaries
As-on survey
Engineering Design

Veris	COLLIERS
-------	----------

C	Progress Plot	06.09.2024	JMc
B	Progress Plot	22.08.2024	JMc
A	Progress Plot	05.08.2024	JMc
Issue	Revisions	Date	Drawn

Local Authority: LCC
Horizontal Meridian: MGA
Vertical Level Datum: AHD D
Level Origin: PM107142(RL39.078)
Scale: 1:250 @ A1
Surveyed: HA
Designed: COLLIERS
Drawn: JMc
Checked: JMc
Plot Date: 08 Sep, 2024
Computer File Ref: 430109-15061-ASW01 C LOCAL.dwg

**AS-CONSTRUCTED
STORMWATER**

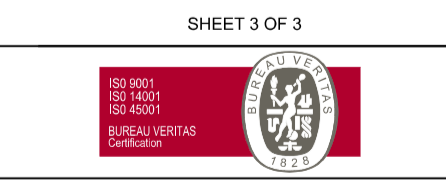

veris
BRISBANE (07) 3666 4700 WHITSUNDAYS (07) 4945 6600
MACKAY (07) 4957 9300 CAIRNS (07) 4232 9400
veris.com.au
ACN 615 735 727
Veris Australia Pty Ltd

Drawing No Issue
430109-15061-ASW01 C

Consulting Engineer's Certification.
I, **Dan Collins** hereby certify that the As Constructed information shown on this plan is a true and correct record of the sizes, types, materials, classes etc., and it corresponds with the relevant approved Engineering Drawings.
Signed: RPEQ No 18631 Dated 25/09/2024

Registered Surveyor's Certification.
We, **VERIS AUSTRALIA P/L** hereby certify that the horizontal and vertical locations, and dimensions shown on this plan are a true and correct record of the As Constructed information.
Signed: Cadastral Surveyor Reg. No 6448
Dated 23/08/2024
Veris Australia Pty Ltd

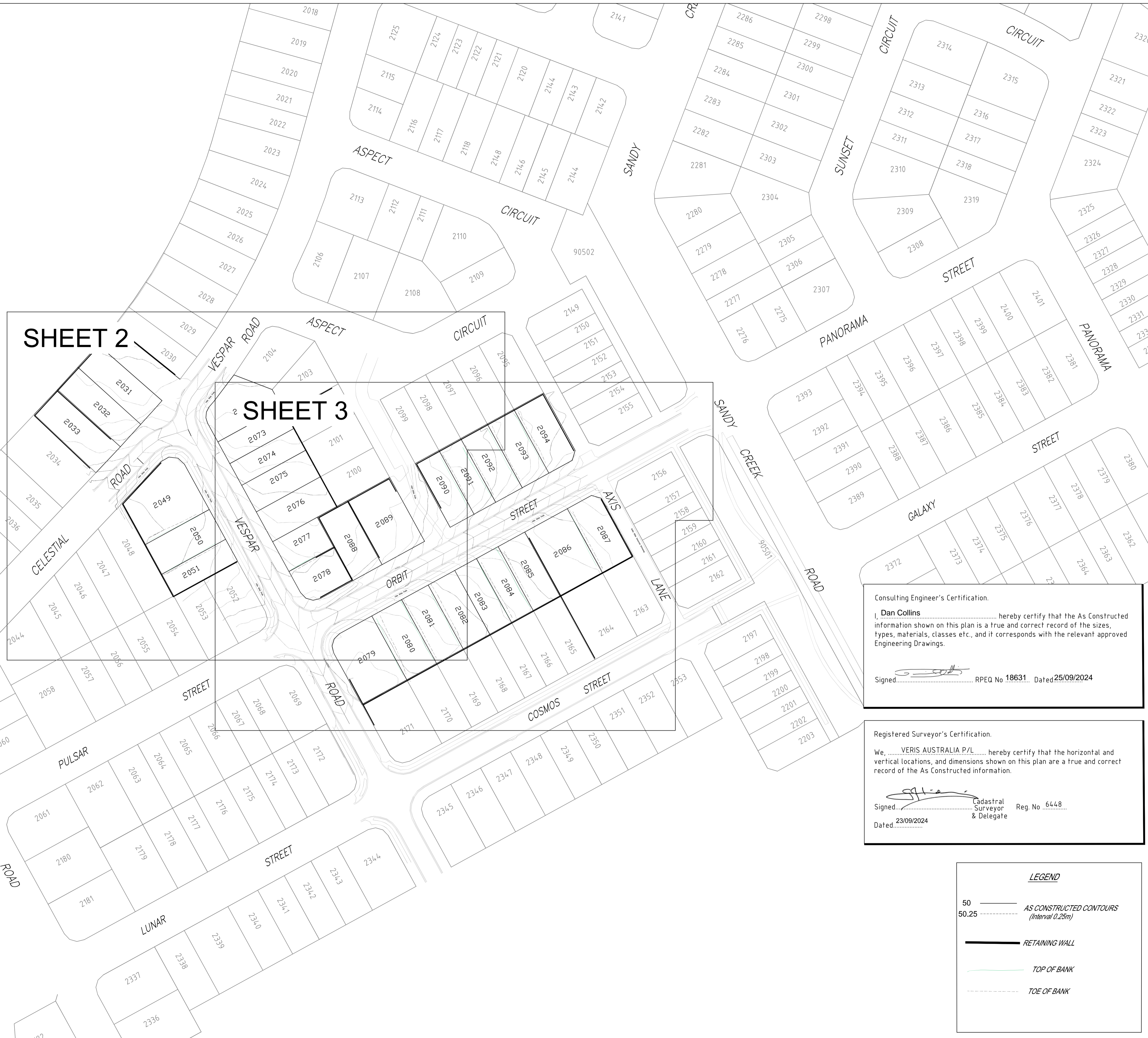

SHEET 2

SHEET 3

Consulting Engineer's Certification.

I, **Dan Collins** hereby certify that the As Constructed information shown on this plan is a true and correct record of the sizes, types, materials, classes etc., and it corresponds with the relevant approved Engineering Drawings.

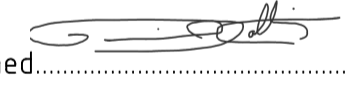
Signed:  RPEQ No 18631 Dated 25/09/2024

Registered Surveyor's Certification.

We, **VERIS AUSTRALIA P/L** hereby certify that the horizontal and vertical locations, and dimensions shown on this plan are a true and correct record of the As Constructed information.

Signed:  Cadastral Surveyor & Delegate Reg. No 6448 Dated 23/09/2024

LEGEND

50	AS CONSTRUCTED CONTOURS (Interval 0.25m)
50.25	RETAINING WALL
	TOP OF BANK
	TOE OF BANK

FLAGSTONE STAGE 5F
For
PEET FLAGSTONE CITY PTY LTD

IMPORTANT NOTES:
This Plan has been prepared for PEET FLAGSTONE CITY PTY LTD to Logan City standards, for the purpose of recording the As Constructed details of a new service constructed under a specific Council Approval and should not be used for any other purpose.
No report is made on any other services, nor any services that may exist before or be constructed after the time of survey, or constructed under any other approval.
The property boundaries, easements and lot numbers shown hereon may be proposed only and subject to registration by the Department of Natural Resources. All property information should be determined from the registered Survey Plans.
All dimensions should be verified and confirmed against the latest information prior to commencement by any person using this plan for building purposes.
Veris Australia Pty Ltd accepts no responsibility for any changes made to construction or otherwise, after the date of the plan. Any discrepancies should be clarified in writing with the relevant Authority prior to commencement of the work.

Copyright © Veris Australia Pty Ltd August 2024
THESE DRAWINGS AND DIMENSIONS ARE COPYRIGHT AND ARE NOT TO BE USED OR REPRODUCED WITHOUT THE WRITTEN PERMISSION OF VERIS

Data Sources	30191-LC-Master(DG) F594 2014.dwg
As-con survey	Veris
Engineering Design	Collins

A	Progress Plot	06.08.2024	JMc
Issue	Revisions	Date	Drawn

Local Authority: LCC
Horizontal Meridian: MGA
Vertical Level Datum: AHD D
Level Origin: PM107142(RL39.078)
Scale: 1:750 @ A1
Surveyed: HA
Designed: Collins
Drawn: JMc
Checked: JMc
Plot Date: 14 Aug. 2024
Computer File Ref: 430109-15061-AFS01-A.LOCAL.dwg

AS-CONSTRUCTED FINAL SURFACE
SHEET 1 OF 3



veris
BRISBANE (07) 3665 4700 WHITSUNDAYS (07) 4643 6000
MACKAY (07) 4957 9700 CAIRNS (07) 4252 8400
veris.com.au
ACN 615 735 727
Veris Australia Pty Ltd

Drawing No 430109-15061-AFS01 Issue

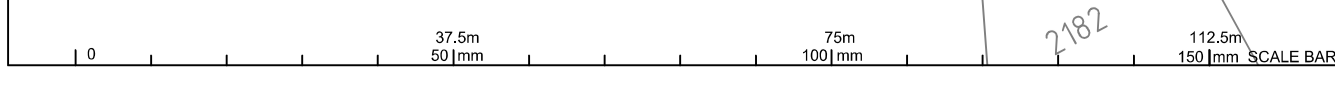



Consulting Engineer's Certification.

I, **Dan Collins**, hereby certify that the As Constructed information shown on this plan is a true and correct record of the sizes, types, materials, classes etc., and if corresponds with the relevant approved Engineering Drawings.

Signed: *[Signature]* RPEQ No 18631.. Dated 25/09/2024

Registered Surveyor's Certification.

We, **VERIS AUSTRALIA P/L**, hereby certify that the horizontal and vertical locations, and dimensions shown on this plan are a true and correct record of the As Constructed information.

Signed: *[Signature]* Cadastral Surveyor & Delegate Reg. No. 6448
 Dated: 23/09/2024

FLAGSTONE STAGE 5F
 For
PEET FLAGSTONE CITY PTY LTD

IMPORTANT NOTES:
 This Plan has been prepared for PEET FLAGSTONE CITY PTY LTD to Logan City standards, for the purpose of recording the As Constructed details of a new service constructed under a specific Council Approval and should not be used for any other purpose.
 No report is made on any other services, nor any services that may exist before or be constructed after, the time of survey, or constructed under any other approval.
 The property boundaries, easements and lot numbers shown herein may be proposed only and subject to registration by the Department of Natural Resources. All property information should be determined from the registered Survey Plans.
 All dimensions should be verified and confirmed against the latest information prior to commencement by any person using this plan for building purposes.
 Veris Australia Pty Ltd accepts no responsibility for any changes made to construction or otherwise, after the date of this plan. Any discrepancies should be clarified in writing with the relevant Authority prior to commencement of the work.

Copyright © Veris Australia Pty Ltd August 2024
 THESE DESIGNS AND DRAWINGS ARE COPYRIGHT AND ARE NOT TO BE USED OR REPRODUCED WITHOUT THE WRITTEN PERMISSION OF VERIS
 Data Sources: 301094-C-Master(DG) FS#4 2014.dwg
 Cadastral Boundaries
 As-con survey Veris
 Engineering Design JMc
 Collars

A	Progress Plot	08.08.2024	JMc
Issue	Revisions	Date	Drawn

Local Authority: LCC
 Horizontal Meridian: MGA
 Vertical Level Datum: AHD D
 Level Origin: PM107142(RL39.078)
 Scale: 1:250 @ A1
 Surveyed: HA
 Designed: Collars
 Drawn: JMc
 Checked: JMc
 Plot Date: 14 Aug, 2024
 Computer File Ref: 430109-15061-AFS01-A-LOCAL.dwg

AS-CONSTRUCTED FINAL SURFACE

SHEET 2 OF 3



veris
 BRISBANE (07) 3666 4700 WHITSUNDAYS (07) 4945 6600
 MACKAY (07) 4957 9700 CAIRNS (07) 4252 9400

veris.com.au
 ACN 615 735 737
 Veris Australia Pty Ltd
 Drawing No 430109-15061-AFS01 A Issue

LEGEND

- 50 — AS CONSTRUCTED CONTOURS
- 50.25 - - - - (Interval 0.25m)
- RETAINING WALL
- TOP OF BANK
- - - - TOE OF BANK





Consulting Engineer's Certification.
 I, **Dan Collins**..... hereby certify that the As Constructed information shown on this plan is a true and correct record of the sizes, types, materials, classes etc., and it corresponds with the relevant approved Engineering Drawings.
 Signed..... RPEQ No 18631... Dated 25/09/2024

Registered Surveyor's Certification.
 We, **VERIS AUSTRALIA P/L**..... hereby certify that the horizontal and vertical locations, and dimensions shown on this plan are a true and correct record of the As Constructed information.
 Signed..... Reg. No
 Dated 23/09/2024 Cadastral Surveyor & Delegate 6448

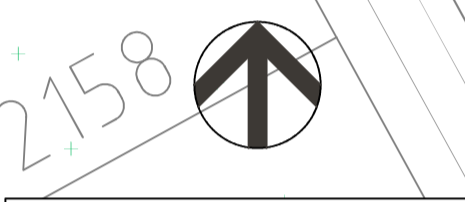

FLAGSTONE STAGE 5F
 For
PEET FLAGSTONE CITY PTY LTD

IMPORTANT NOTES:
 This Plan has been prepared for PEET FLAGSTONE CITY PTY LTD to Logan City standards, for the purpose of recording the As Constructed details of a new service constructed under a specific Council Approval and should not be used for any other purpose.
 No report is made on any other services, nor any services that may exist before or be constructed after, the time of survey, or constructed under any other approval.
 The property boundaries, easements and lot numbers shown hereon may be proposed only and subject to registration by the Department of Natural Resources. All property information should be determined from the registered Survey Plans.
 All dimensions should be verified and confirmed against the latest information prior to commencement by any person using this plan for building purposes.
 Veris Australia Pty Ltd accepts no responsibility for any changes made to construction or otherwise, after the date of this plan. Any discrepancies should be clarified in writing with the relevant Authority prior to commencement of the work.

Copyright © Veris Australia Pty Ltd August 2024.
 THESE DESIGNS AND DRAWINGS ARE COPYRIGHT AND ARE NOT TO BE USED OR REPRODUCED WITHOUT THE WRITTEN PERMISSION OF VERIS
 Data Sources: 301094.C-Master(DG) FS#4 2014.dwg
 Cadastral Boundaries
 As-con survey Veris
 Engineering Design Collers

Issue	Revision	Date	Drawn
A	Progress Plot	08.08.2024	JMc

Local Authority: LCC
 Horizontal Meridian: MGA
 Vertical Level Datum: AHD D
 Level Origin: PM107142(RL39.078)
 Scale: 1:250 @ A1
 Surveyed: HA
 Designed: Collers
 Drawn: JMc
 Checked: JMc
 Plot Date: 14 Aug, 2024
 Computer File Ref: 430109-15061-AFS01-A.LOCAL.dwg

AS-CONSTRUCTED
FINAL SURFACE

SHEET 3 OF 3



veris
 BRISBANE (07) 3666 4700 WHITSUNDAYS (07) 4945 6600
 MACKAY (07) 4957 9700 CAIRNS (07) 4252 9400
 veris.com.au
 ACN 616 736 737
 Veris Australia Pty Ltd
 Drawing No Issue
430109-15061-AFS01 A

LEGEND
 50 — AS CONSTRUCTED CONTOURS
 50.25 - - - - (Interval 0.25m)
 ——— RETAINING WALL
 ——— TOP OF BANK
 - - - - - TOE OF BANK