

Building Envelope Key - Front Loaded Allotment

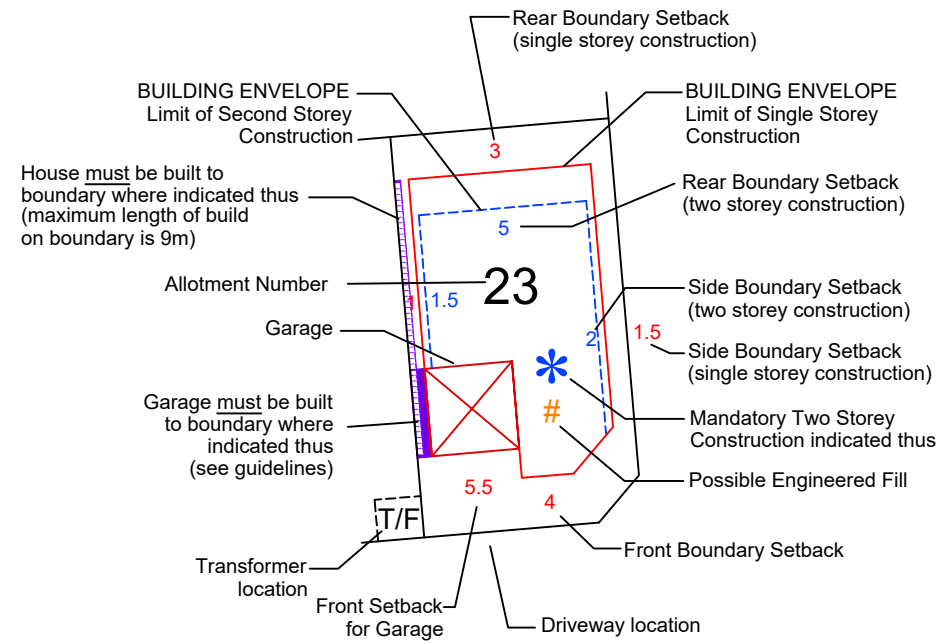

- Denotes Articulation Zone (refer Urban Design Guidelines)
- Denotes Retaining Wall and Fence by Developer

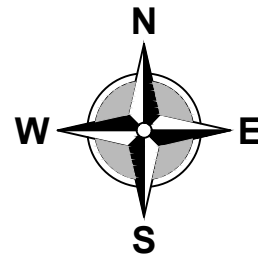

20A1673BEP2 Rev A

Alexander & Symonds Pty Ltd
 11 King William Street Kent Town,
 South Australia 5067
 PO Box 1000 Kent Town, SA 5071
 DX 209 ABN 93007 753 988

T (08) 8130 1666
F (08) 8362 0099
W www.alexander.com.au
E adelaide@alexander.com.au

+ Property + Land Development +
 + Construction + Mining +
 + Spatial Information Management +



Building Envelope Key - Front Loaded Allotment

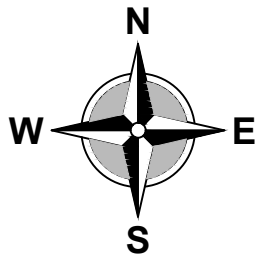
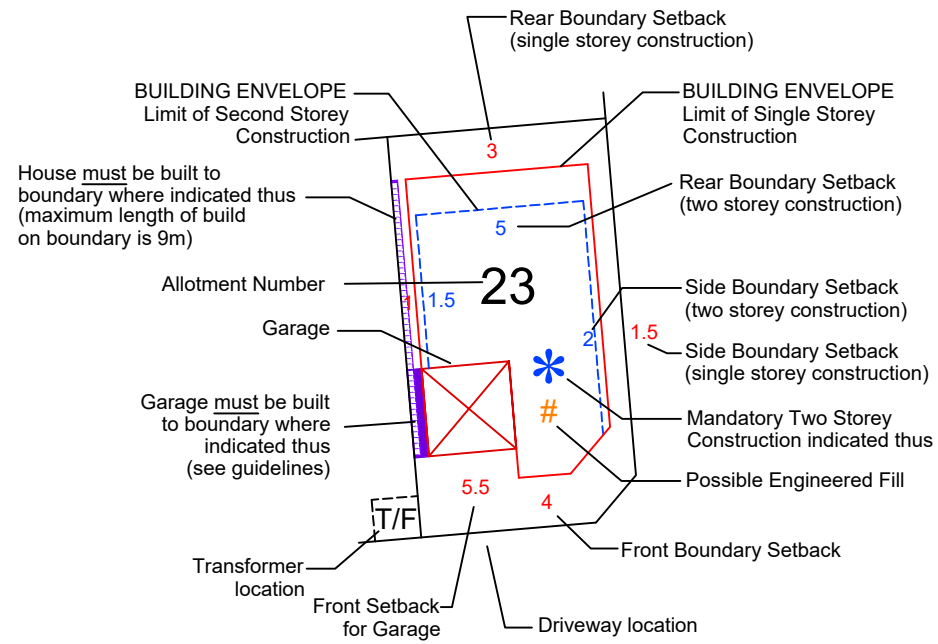

- Denotes Retaining Wall and 2.1m high Fence by Developer
- Denotes Retaining Wall and 2.4m high Fence by Developer

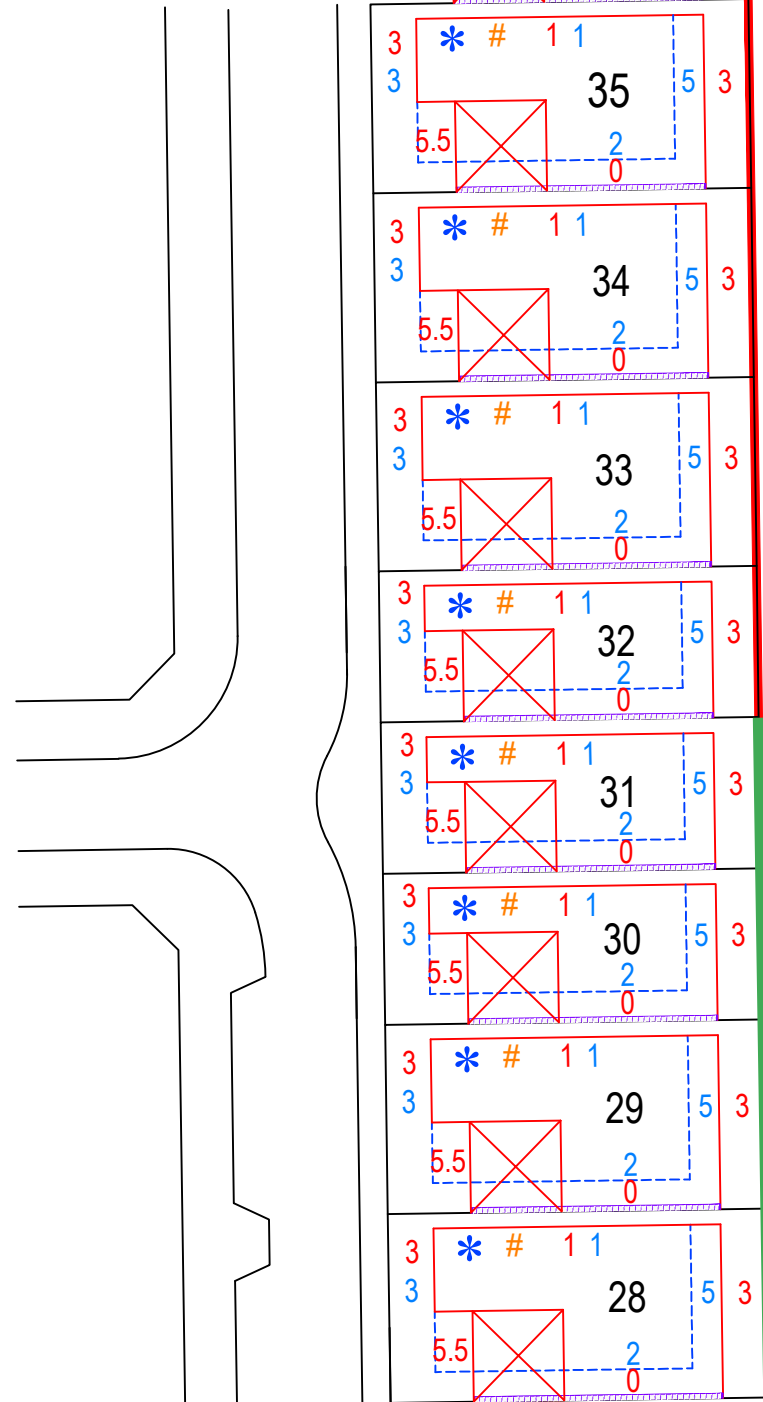

20A1673BEP3A Rev A

Alexander & Symonds Pty Ltd
 11 King William Street Kent Town,
 South Australia 5067
 PO Box 1000 Kent Town, SA 5071
 DX 209 ABN 93007 753 988

T (08) 8130 1666
F (08) 8362 0099
W www.alexander.com.au
E adelaide@alexander.com.au

+ Property + Land Development +
 + Construction + Mining +
 + Spatial Information Management +

