

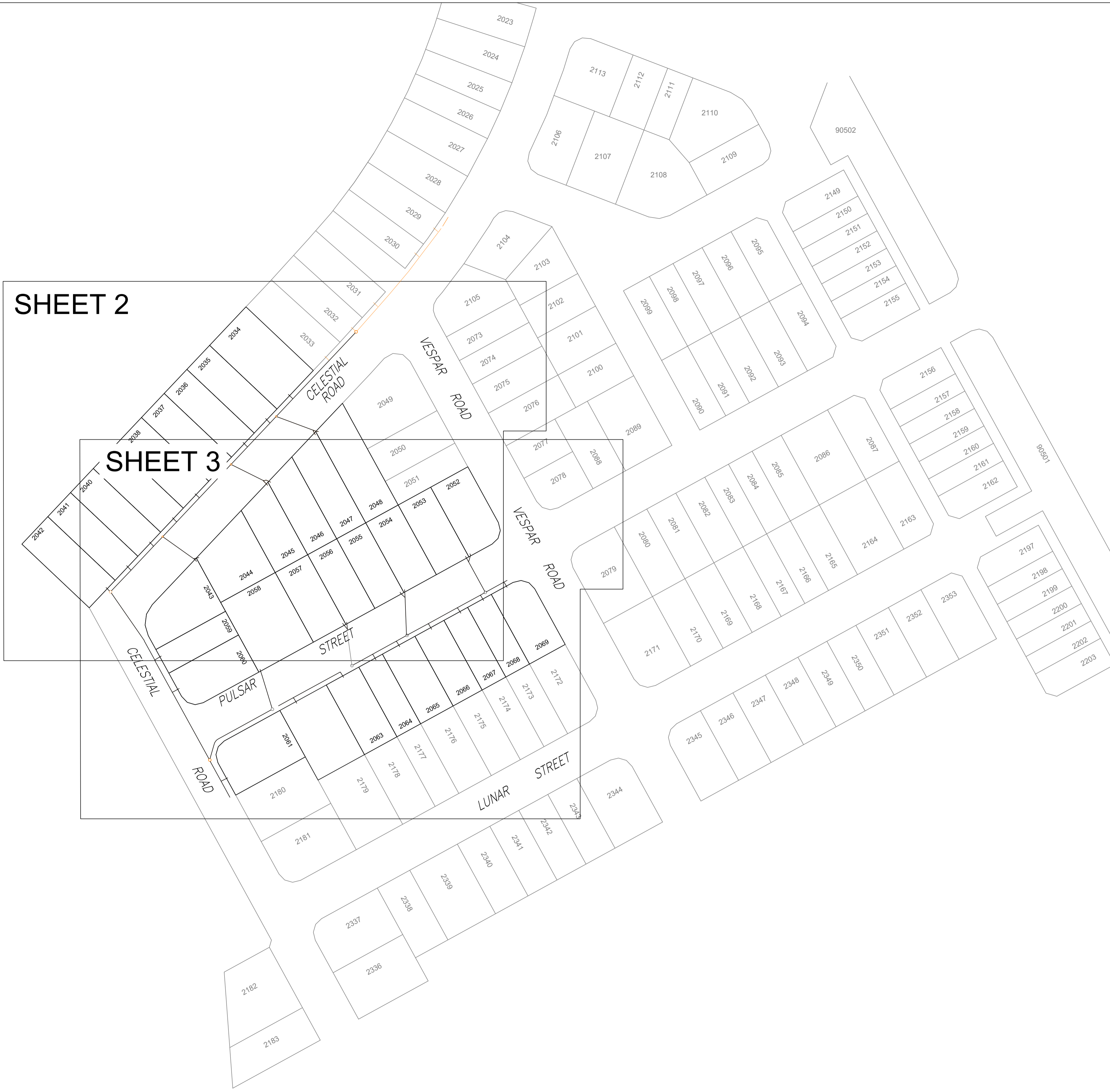

SHEET 2

SHEET 3



**FLAGSTONE  
STAGE 5G**  
For  
**PEET FLAGSTONE  
CITY PTY LTD**

IMPORTANT NOTES:  
This Plan has been prepared for PEET FLAGSTONE CITY PTY LTD to Logon City standards, for the purpose of recording the As Constructed details of a new service constructed under a specific Council Approval and should not be used for any other purpose.  
No report is made on any other services, nor any services that may exist before or be constructed after, the time of survey, or constructed under any other approval.  
The property boundaries, easements and lot numbers shown hereon may be proposed only and subject to registration by the Department of Natural Resources. All property information should be determined from the registered Survey Plans.  
All dimensions should be verified and confirmed against the latest information prior to commencement by any person using this plan for building purposes.  
Veris Australia Pty Ltd accepts no responsibility for any changes made to construction or otherwise, after the date of this plan. Any discrepancies should be clarified in writing with the relevant Authority prior to commencement of the work.

Copyright © Veris Australia Pty Ltd, May 2024.  
THESE DESIGNS AND DRAWINGS ARE COPYRIGHT AND ARE NOT TO BE USED OR REPRODUCED WITHOUT THE WRITTEN PERMISSION OF VERIS  
Data Sources 30109-LC-Master(DF) FS94 2014.dwg  
Cadastral Boundaries  
As-on survey Veris  
Engineering Design COLLIERIES

Issue	Revisions	Date	Drawn
B	Progress Plot	29.05.2024	JMc
A	Progress Plot	22.05.2024	JMc

Local Authority: LCC  
Horizontal Meridian: MGA  
Vertical Level Datum: AHD D  
Level Origin: PM107142(RL39.078)  
Scale: 1:750 @ A1  
Surveyed: HA  
Designed: COLLIERIES  
Drawn: JMc  
Checked: JMc  
Plot Date: 02 Jul, 2024  
Computer File Ref: 430109-15071-AS01 B LOCAL.dwg

**AS-CONSTRUCTED  
SEWER**  
SHEET 1 OF 3



**veris**  
BRISBANE (07) 3668 4700 WHITSUNDAYS (07) 4945 6600  
MACKAY (07) 4957 9700 CAIRNS (07) 4232 9400  
veris.com.au  
ACN 615 735 727  
Veris Australia Pty Ltd

Drawing No 430109-15071-AS01 B Issue

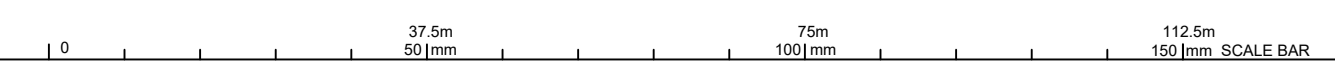



**FLAGSTONE  
STAGE 5G**  
For  
**PEET FLAGSTONE  
CITY PTY LTD**

**IMPORTANT NOTES:**  
This Plan has been prepared for PEET FLAGSTONE CITY PTY LTD to Logan City standards, for the purpose of recording the As Constructed details of a new sewer constructed under a specific Council Approval and should not be used for any other purpose.  
No report is made on any other services, nor any services that may exist before or be constructed after, the time of survey, or constructed under any other approval.  
The property boundaries, easements and lot numbers shown hereon may be proposed only and subject to registration by the Department of Natural Resources. All property information should be determined from the registered Survey Plans.  
All dimensions should be verified and confirmed against the latest information prior to commencement by any person using this plan for building purposes.  
Veris Australia Pty Ltd accepts no responsibility for any changes made to construction or otherwise, after the date of this plan. Any discrepancies should be clarified in writing with the relevant Authority prior to commencement of the work.

Copyright © Veris Australia Pty Ltd, May 2024.  
THESE DESIGNS AND DRAWINGS ARE COPYRIGHT AND ARE NOT TO BE USED OR REPRODUCED WITHOUT THE WRITTEN PERMISSION OF VERIS

Issue	Revisions	Date	Drawn
B	Progress Plot	29.06.2024	JMc
A	Progress Plot	22.05.2024	JMc

Local Authority: LCC  
Horizontal Meridian: MGA  
Vertical Level Datum: AHD D  
Level Origin: PM107142(RL39.078)  
Scale: 1:250 @ A1  
Surveyed: HA  
Designed: COLLIERIES  
Drawn: JMc  
Checked: JMc  
Plot Date: 02 Jul, 2024  
Computer File Ref: 430109-15071-AS01 B LOCAL.dwg

**AS-CONSTRUCTED  
SEWER**

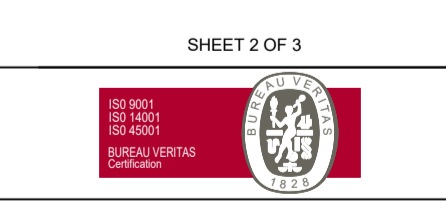

**veris**  
BRISBANE (07) 3668 4700  
MACKAY (07) 4957 9700  
WHITSUNDAYS (07) 4945 6600  
CAIRNS (07) 4222 9400  
veris.com.au  
ACN 615 735 727  
Veris Australia Pty Ltd  
Drawing No: 430109-15071-AS01 B Issue: 1



**FLAGSTONE  
STAGE 5G**  
For  
**PEET FLAGSTONE  
CITY PTY LTD**

IMPORTANT NOTES:  
This Plan has been prepared for PEET FLAGSTONE CITY PTY LTD to Logan City standards, for the purpose of recording the As Constructed details of a new service constructed under a specific Council Approval and should not be used for any other purpose.  
No report is made on any other services, nor any services that may exist before or be constructed after, the time of survey, or constructed under any other approval.  
The property boundaries, easements and lot numbers shown hereon may be proposed only and subject to registration by the Department of Natural Resources. All property information should be determined from the registered Survey Plans.  
All dimensions should be verified and confirmed against the latest information prior to commencement by any person using this plan for building purposes.  
Veris Australia Pty Ltd accepts no responsibility for any changes made to construction or otherwise, after the date of this plan. Any discrepancies should be clarified in writing with the relevant Authority prior to commencement of the work.

Copyright © Veris Australia Pty Ltd, May 2024.  
THESE DESIGNS AND DRAWINGS ARE COPYRIGHT AND ARE NOT TO BE USED OR REPRODUCED WITHOUT THE WRITTEN PERMISSION OF VERIS  
Data Sources: 30109-LC-Master(DP) FS94 2014.dwg  
Cadastral Boundaries  
As-on survey: Veris  
Engineering Design: COLLIERIES

Issue	Revisions	Date	Drawn
B	Progress Plot	29.06.2024	JMc
A	Progress Plot	22.05.2024	JMc

Local Authority: LCC  
Horizontal Meridian: MGA  
Vertical Level Datum: AHD D  
Level Origin: PM107142(RL39.078)  
Scale: 1:250 @ A1  
Designed: HA  
Drawn: COLLIERIES  
Checked: JMc  
Plot Date: 02 Jul, 2024  
Computer File Ref: 430109-15071-AS01 B LOCAL.dwg

**AS-CONSTRUCTED  
SEWER**



**veris**

BRISBANE (07) 3668 4700    WHITSUNDAYS (07) 4945 6600  
MACKAY (07) 4957 9700    CAIRNS (07) 4222 9400

veris.com.au  
ACN 615 735 727  
Veris Australia Pty Ltd

Drawing No: 430109-15071-AS01 B    Issue: B

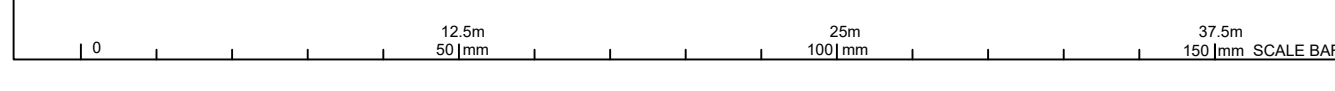



SHEET 2

SHEET 3

(3.076ha)

**FLAGSTONE  
STAGE 5G**  
For  
**PEET FLAGSTONE  
CITY PTY LTD**

IMPORTANT NOTES:  
This Plan has been prepared for PEET FLAGSTONE CITY PTY LTD to Logan City standards, for the purpose of recording the As Constructed details of a new service constructed under a specific Council Approval and should not be used for any other purpose.

No report is made on any other services, nor any services that may exist before or be constructed after, the time of survey, or constructed under any other approval.

The property boundaries, easements and lot numbers shown hereon may be proposed only and subject to registration by the Department of Natural Resources. All property information should be determined from the registered Survey Plans.

All dimensions should be verified and confirmed against the latest information prior to commencement by any person using this plan for building purposes.

Veris Australia Pty Ltd accepts no responsibility for any changes made to construction or otherwise, after the date of this plan. Any discrepancies should be clarified in writing with the relevant Authority prior to commencement of the work.

Copyright © Veris Australia Pty Ltd, June 2024.  
THESE DESIGNS AND DRAWINGS ARE COPYRIGHT AND ARE NOT TO BE USED OR REPRODUCED WITHOUT THE WRITTEN PERMISSION OF VERIS

Data Sources 30109-LC-Master(DP) FS94 2014.dwg  
Cadastral Boundaries  
As-on survey Veris  
Engineering Design COLLIERIES

Issue	Revisions	Date	Drawn
A	Progress Plot	20.06.2024	JMc

Local Authority: LCC  
Horizontal Meridian: MGA  
Vertical Level Datum: AHD D  
Level Origin: PM107142(RL39.078)  
Scale: 1:750 @ A1  
Surveyed: HA  
Designed: COLLIERIES  
Drawn: JMc  
Checked: JMc  
Plot Date: 02 Jul, 2024  
Computer File Ref: 430109-15071-AW01 A LOCAL.dwg

**AS-CONSTRUCTED**

**WATER**

SHEET 1 OF 3



**veris**

**BRISBANE** (07) 3668 4700  
**WHITSUNDAYS** (07) 4945 6600  
**MACKAY** (07) 4957 8700  
**CAIRNS** (07) 4232 9400

veris.com.au  
ACN 615 735 727  
Veris Australia Pty Ltd

Drawing No 430109-15071-AW01 A Issue

37.5m 50mm 75m 100mm 112.5m 150mm SCALE BAR



**FLAGSTONE  
STAGE 5G**  
For  
**PEET FLAGSTONE  
CITY PTY LTD**

**IMPORTANT NOTES:**  
This Plan has been prepared for PEET FLAGSTONE CITY PTY LTD to Logan City standards, for the purpose of recording the As Constructed details of a new service constructed under a specific Council Approval and should not be used for any other purpose.  
No report is made on any other services, nor any services that may exist before or be constructed after, the time of survey, or constructed under any other approval.  
The property boundaries, easements and lot numbers shown hereon may be proposed only and subject to registration by the Department of Natural Resources. All property information should be determined from the registered Survey Plans.  
All dimensions should be verified and confirmed against the latest information prior to commencement by any person using this plan for building purposes.  
Veris Australia Pty Ltd accepts no responsibility for any changes made to construction or otherwise, after the date of this plan. Any discrepancies should be clarified in writing with the relevant Authority prior to commencement of the work.

Copyright © Veris Australia Pty Ltd, June 2024.  
THESE DESIGNS AND DRAWINGS ARE COPYRIGHT AND ARE NOT TO BE USED OR REPRODUCED WITHOUT THE WRITTEN PERMISSION OF VERIS

Data Sources 30109-LC-Master(DP) FS94 2014.dwg  
Cadastral Boundaries  
As-on survey Veris  
Engineering Design COLLIER'S

Issue	Revisions	Date	JMc	Drawn
A	Progress Plot	20.06.2024	JMc	

Local Authority: LCC  
Horizontal Meridian: MGA  
Vertical Level Datum: AHD D  
Level Origin: PM107142(RL39.078)  
Scale: 1:250 @ A1  
Surveyed: HA  
Designed: COLLIER'S  
Drawn: JMc  
Checked: JMc  
Plot Date: 02 Jul, 2024  
Computer File Ref: 430109-15071-AW01 A LOCAL.dwg

**AS-CONSTRUCTED  
WATER**



BRISBANE (07) 3668 4700 WHITSUNDAYS (07) 4945 6800  
MACKAY (07) 4957 9700 CAIRNS (07) 4232 9400

veris.com.au  
ACN 615 735 727  
Veris Australia Pty Ltd

Drawing No 430109-15071-AW01 A Issue

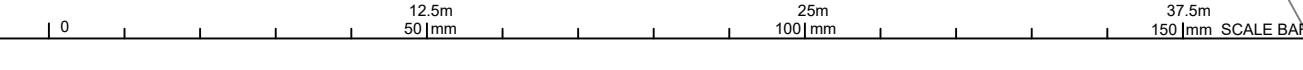



**FLAGSTONE  
STAGE 5G**  
For  
**PEET FLAGSTONE  
CITY PTY LTD**

**IMPORTANT NOTES:**  
This Plan has been prepared for PEET FLAGSTONE CITY PTY LTD to Logan City standards, for the purpose of recording the As Constructed details of a new service constructed under a specific Council Approval and should not be used for any other purpose.  
No report is made on any other services, nor any services that may exist before or be constructed after, the time of survey, or constructed under any other approval.  
The property boundaries, easements and lot numbers shown hereon may be proposed only and subject to registration by the Department of Natural Resources. All property information should be determined from the registered Survey Plans.  
All dimensions should be verified and confirmed against the latest information prior to commencement by any person using this plan for building purposes.  
Veris Australia Pty Ltd accepts no responsibility for any changes made to construction or otherwise, after the date of this plan. Any discrepancies should be clarified in writing with the relevant Authority prior to commencement of the work.

Copyright © Veris Australia Pty Ltd, June 2024.  
**THESE DESIGNS AND DRAWINGS ARE COPYRIGHT AND ARE NOT TO BE USED OR REPRODUCED WITHOUT THE WRITTEN PERMISSION OF VERIS**

Data Sources: 30109-LC-Master(DP) FS94 2014.dwg  
Cadastral Boundaries: As-on survey  
Engineering Design: Veris COLLIERIES

Issue	Revisions	Date	JMc	Drawn
A	Progress Plot	20.06.2024	JMc	Drawn

Local Authority: LCC  
Horizontal Meridian: MGA  
Vertical Level Datum: AHD D  
Level Origin: PM107142(RL39.078)  
Scale: 1:250 @ A1  
Surveyed: HA  
Designed: COLLIERIES  
Drawn: JMc  
Checked: JMc  
Plot Date: 02 Jul, 2024  
Computer File Ref: 430109-15071-AW01 A LOCAL.dwg

**AS-CONSTRUCTED  
WATER**

SHEET 3 OF 3

**veris**

BRISBANE (07) 3668 4700  
WHITSUNDAYS (07) 4945 6600  
MACKAY (07) 4957 9700  
CAIRNS (07) 4232 9400

veris.com.au  
ACN 615 735 727  
Veris Australia Pty Ltd

Drawing No: 430109-15071-AW01 A Issue

