

**SHEET 2**

**SHEET 3**

**FLAGSTONE  
STAGE 5F**  
For  
**PEET FLAGSTONE  
CITY PTY LTD**

**IMPORTANT NOTES:**  
This Plan has been prepared for PEET FLAGSTONE CITY PTY LTD to Logan City standards, for the purpose of recording the As-Constructed details of a new service constructed under a specific Council Approval and should not be used for any other purpose.  
No report is made on any other services, nor any services that may exist before or be constructed after the time of survey, or constructed under any other approval.  
The property boundaries, easements and lot numbers shown hereon may be proposed only and subject to registration by the Department of Natural Resources. All property information should be determined from the registered Survey Plans.  
All dimensions should be verified and confirmed against the latest information prior to commencement by any person using this plan for building purposes.  
Veris Australia Pty Ltd accepts no responsibility for any changes made to construction or otherwise, after the date of this plan. Any discrepancies should be clarified in writing with the relevant Authority prior to commencement of the work.

Copyright © Veris Australia Pty Ltd, May 2024.  
**THESE DESIGNS AND DRAWINGS ARE COPYRIGHT AND ARE NOT TO BE USED OR REPRODUCED WITHOUT THE WRITTEN PERMISSION OF VERIS**

**Data Sources:** 3D/109-LC-Master(D0) F594 2014.dwg  
Cadastral Boundaries As-con survey Veris Engineering Design  
COLLIERS

Issue	Revisions	Date	Drawn
A	Progress Plot	22/05/2024	JMc

Local Authority: LCC  
Horizontal Meridian: MGA  
Vertical Level Datum: AHD D  
Level Origin: PM107142(RL39.078)  
Scale: 1:750 @ A1  
Surveyed: HA  
Designed: COLLIERS  
Drawn: JMc  
Checked: JMc  
Plot Date: 22 May, 2024  
Computer File Ref: 430109-15061-AW01 A LOCAL.dwg

**AS-CONSTRUCTED  
WATER**  
SHEET 1 OF 3



BRISBANE (07) 3665 4700 WHITSUNDAYS (07) 4645 9900  
MACKAY (07) 4967 9700 CAIRNS (07) 4252 9400

veris.com.au  
ACN 615 735 727  
Veris Australia Pty Ltd

Drawing No 430109-15061-AW01 Issue A

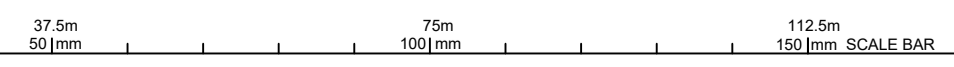



**FLAGSTONE  
STAGE 5F**  
For  
**PEET FLAGSTONE  
CITY PTY LTD**

**IMPORTANT NOTES:**  
This Plan has been prepared for PEET FLAGSTONE CITY PTY LTD to Logan City standards, for the purpose of recording the As Constructed details of a new service constructed under a specific Council Approval and should not be used for any other purpose.  
No report is made on any other services, nor any services that may exist before or be constructed after, the time of survey, or constructed under any other approval.  
The property boundaries, easements and lot numbers shown hereon may be proposed only and subject to registration by the Department of Natural Resources. All property information should be determined from the registered Survey Plans.  
All dimensions should be verified and confirmed against the latest information prior to commencement by any person using this plan for building purposes.  
Veris Australia Pty Ltd accepts no responsibility for any changes made to construction or otherwise, after the date of this plan. Any discrepancies should be clarified in writing with the relevant Authority prior to commencement of the work.

Copyright © Veris Australia Pty Ltd, May 2024.  
THESE DESIGNS AND DRAWINGS ARE COPYRIGHT AND ARE NOT TO BE USED OR REPRODUCED WITHOUT THE WRITTEN PERMISSION OF VERIS  
Data Sources 30109-LC-Master(DO) F594 2014.dwg  
Cadastral Boundaries  
As-on survey Veris  
Engineering Design COLLIERIES

Issue	Revisions	Date	Drawn
A	Progress Plot	22.05.2024	JMc

Local Authority: LCC  
Horizontal Meridian: MGA  
Vertical Level Datum: AHD D  
Level Origin: PM107142(RL39.078)  
Scale: 1:250 @ A1  
Surveyed: HA  
Designed: COLLIERIES  
Drawn: JMc  
Checked: JMc  
Plot Date: 22 May, 2024  
Computer File Ref: 430109-15061-AW01 A LOCAL.dwg

**AS-CONSTRUCTED  
WATER**  
SHEET 2 OF 3



**veris**  
BRISBANE (07) 3668 4700 WHITSUNDAYS (07) 4945 6600  
MACKAY (07) 4957 9700 CAIRNS (07) 4232 9400  
veris.com.au  
ACN 615 735 727  
Veris Australia Pty Ltd

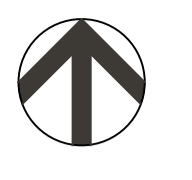

**FLAGSTONE  
STAGE 5F**  
For  
**PEET FLAGSTONE  
CITY PTY LTD**

**IMPORTANT NOTES:**  
This Plan has been prepared for PEET FLAGSTONE CITY PTY LTD to Logan City standards, for the purpose of recording the As Constructed details of a new service constructed under a specific Council Approval and should not be used for any other purpose.  
No report is made on any other services, nor any services that may exist before or be constructed after, the time of survey, or constructed under any other approval.  
The property boundaries, easements and lot numbers shown hereon may be proposed only and subject to registration by the Department of Natural Resources. All property information should be determined from the registered Survey Plans.  
All dimensions should be verified and confirmed against the latest information prior to commencement by any person using this plan for building purposes.  
Veris Australia Pty Ltd accepts no responsibility for any changes made to construction or otherwise, after the date of this plan. Any discrepancies should be clarified in writing with the relevant Authority prior to commencement of the work.

Copyright © Veris Australia Pty Ltd, May 2024.  
**THESE DESIGNS AND DRAWINGS ARE COPYRIGHT AND ARE NOT TO BE USED OR REPRODUCED WITHOUT THE WRITTEN PERMISSION OF VERIS**

Data Sources 30109-LC-Master(DO) F594 2014.dwg  
Cadastral Boundaries As-on survey Veris  
Engineering Design COLLIER'S

Issue	Revisions	Date	Drawn
A	Progress Plot	22.05.2024	JMc

Local Authority: LCC  
Horizontal Meridian: MGA  
Vertical Level Datum: AHD D  
Level Origin: PM107142(RL39.078)  
Scale: 1:250 @ A1  
Surveyed: HA  
Designed: COLLIER'S  
Drawn: JMc  
Checked: JMc  
Plot Date: 22 May, 2024  
Computer File Ref: 430109-15061-AW01 A LOCAL.dwg

**AS-CONSTRUCTED  
WATER**



**veris**  
BRISBANE (07) 3668 4700 WHITSUNDAYS (07) 4945 6800  
MACKAY (07) 4957 8700 CAIRNS (07) 4232 9400  
veris.com.au  
ACN 615 735 727  
Veris Australia Pty Ltd

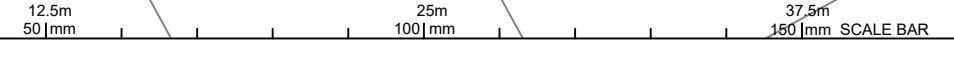

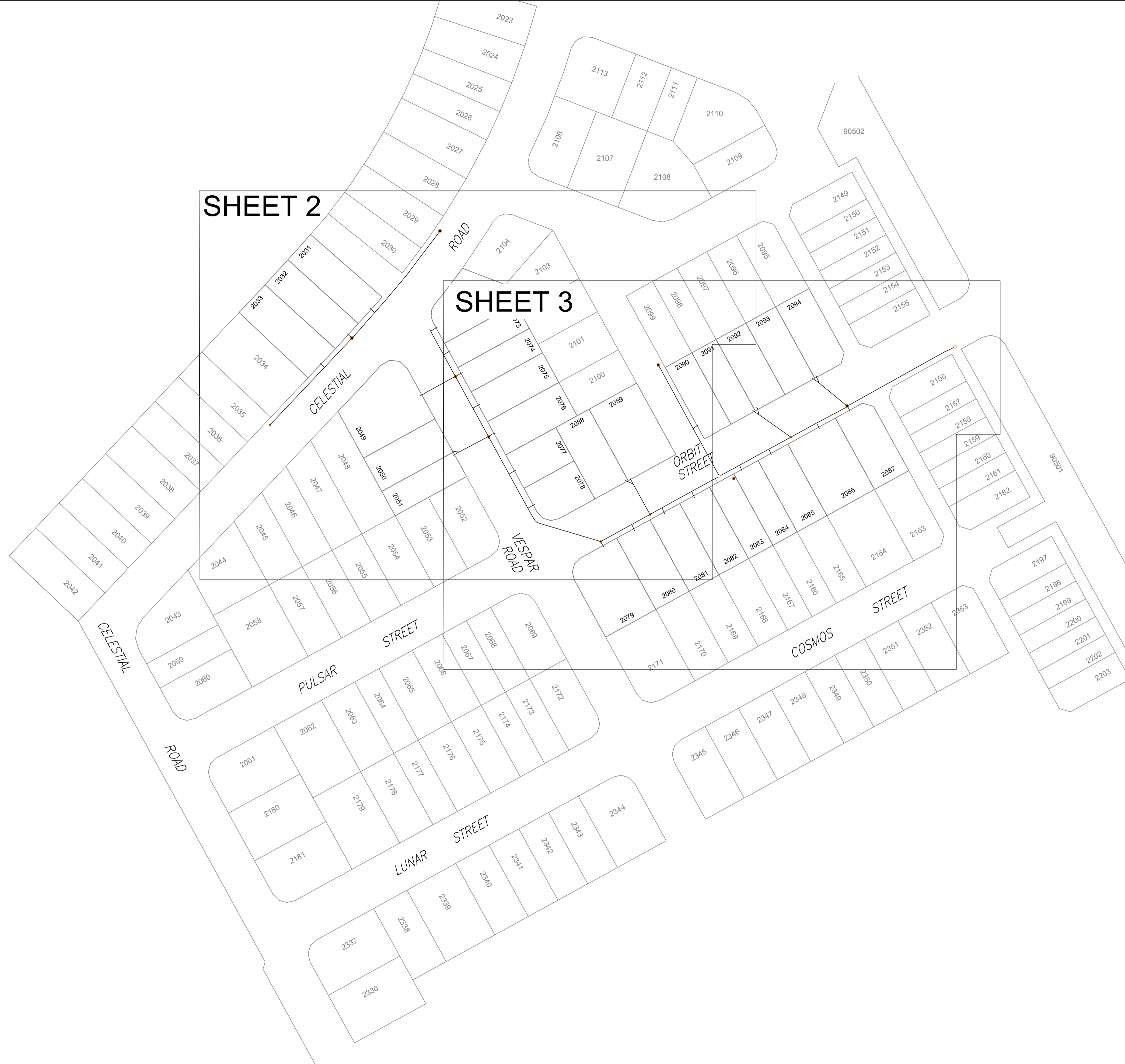

**FLAGSTONE  
STAGE 5F**  
For  
**PEET FLAGSTONE  
CITY PTY LTD**

**IMPORTANT NOTES:**  
This Plan has been prepared for PEET FLAGSTONE CITY PTY LTD to Logan City standards, for the purpose of recording the As-Constructed details of a new service constructed under a specific Council Approval and should not be used for any other purpose.  
No report is made on any other services, nor any services that may exist before or be constructed after, the time of survey, or constructed under any other approval.  
The property boundaries, easements and lot numbers shown hereon may be proposed only and subject to registration by the Department of Natural Resources. All property information should be determined from the registered Survey Plans.  
All dimensions should be verified and confirmed against the latest information prior to commencement by any person using this plan for building purposes.  
Veris Australia Pty Ltd accepts no responsibility for any changes made to construction or otherwise, after the date of this plan. Any discrepancies should be clarified in writing with the relevant Authority prior to commencement of the work.

Copyright © Veris Australia Pty Ltd, May 2024.  
THESE DESIGNS AND DRAWINGS ARE COPYRIGHT AND ARE NOT TO BE USED OR REPRODUCED WITHOUT THE WRITTEN PERMISSION OF VERIS

Data Sources: 30109-LC-Master(DO) F594 2014.dwg  
Cadastral Boundaries  
As-on survey: Veris  
Engineering Design: COLLIERIS

Issue	Revisions	Date	Drawn
C	Progress Plot	12.07.2024	JMc
B	Progress Plot	29.05.2024	JMc
A	Progress Plot	02.05.2024	JMc

Local Authority: LCC  
Horizontal Meridian: MGA  
Vertical Level Datum: AHD D  
Level Origin: PM107142(RL39.078)  
Scale: 1:750 @ A1  
Surveyed: HA  
Designed: COLLIERIS  
Drawn: JMc  
Checked: JMc  
Plot Date: 17 Jul, 2024  
Computer File Ref: 430109-15061-AS01 C LOCAL.dwg

**AS-CONSTRUCTED  
SEWER**  
SHEET 1 OF 3



BRISBANE (07) 3668 4700 WHITSUNDAYS (07) 4945 6600  
MACKAY (07) 4957 8700 CAIRNS (07) 4232 9400

veris.com.au  
ACN 615 735 727  
Veris Australia Pty Ltd

Drawing No: 430109-15061-AS01 C Issue

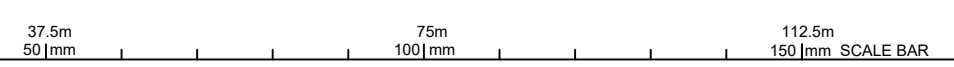



**FLAGSTONE  
STAGE 5F**  
For  
**PEET FLAGSTONE  
CITY PTY LTD**

**IMPORTANT NOTES:**  
This Plan has been prepared for PEET FLAGSTONE CITY PTY LTD to Logan City standards, for the purpose of recording the As Constructed details of a new service constructed under a specific Council Approval and should not be used for any other purpose.  
No report is made on any other services, nor any services that may exist before or be constructed after, the time of survey, or constructed under any other approval.  
The property boundaries, easements and lot numbers shown hereon may be proposed only and subject to registration by the Department of Natural Resources. All property information should be determined from the registered Survey Plans.  
All dimensions should be verified and confirmed against the latest information prior to commencement by any person using this plan for building purposes.  
Veris Australia Pty Ltd accepts no responsibility for any changes made to construction or otherwise, after the date of this plan. Any discrepancies should be clarified in writing with the relevant Authority prior to commencement of the work.

Copyright © Veris Australia Pty Ltd, May 2024.  
THESE DESIGNS AND DRAWINGS ARE COPYRIGHT AND ARE NOT TO BE USED OR REPRODUCED WITHOUT THE WRITTEN PERMISSION OF VERIS  
Data Sources: 30109-LC-Master(DB) F594 2014.dwg  
Cadastral Boundaries  
As-on survey Veris  
Engineering Design COLLIER'S

Issue	Revisions	Date	Drawn
C	Progress Plot	12.07.2024	JMc
B	Progress Plot	29.05.2024	JMc
A	Progress Plot	02.05.2024	JMc

Local Authority: LCC  
Horizontal Meridian: MGA  
Vertical Level Datum: AHD D  
Level Origin: PM107142(RL39.078)  
Scale: 1:250 @ A1  
Surveyed: HA  
Designed: COLLIER'S  
Drawn: JMc  
Checked: JMc  
Plot Date: 17 Jul, 2024  
Computer File Ref: 430109-15061-AS01 C LOCAL.dwg

**AS-CONSTRUCTED  
SEWER**

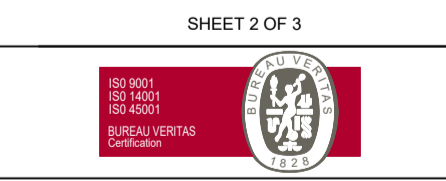

**veris**  
BRISBANE (07) 3666 4700 WHITSUNDAYS (07) 4945 6600  
MACKAY (07) 4957 9700 CAIRNS (07) 4232 9400  
veris.com.au  
ACN 615 735 727  
Veris Australia Pty Ltd  
Drawing No 430109-15061-AS01 C Issue

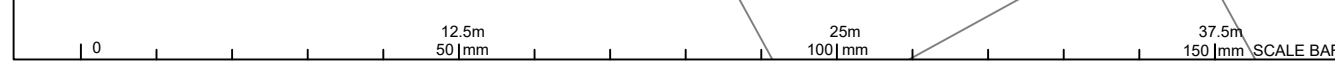



**FLAGSTONE  
STAGE 5F**  
For  
**PEET FLAGSTONE  
CITY PTY LTD**

**IMPORTANT NOTES:**  
This Plan has been prepared for PEET FLAGSTONE CITY PTY LTD to Logan City standards, for the purpose of recording the As-Constructed details of a new service constructed under a specific Council Approval and should not be used for any other purpose.

No report is made on any other services, nor any services that may exist before or be constructed after, the time of survey, or constructed under any other approval.

The property boundaries, easements and lot numbers shown hereon may be proposed only and subject to registration by the Department of Natural Resources. All property information should be determined from the registered Survey Plans.

All dimensions should be verified and confirmed against the latest information prior to commencement by any person using this plan for building purposes.

Veris Australia Pty Ltd accepts no responsibility for any changes made to construction or otherwise, after the date of this plan. Any discrepancies should be clarified in writing with the relevant Authority prior to commencement of the work.

Copyright © Veris Australia Pty Ltd, May 2024.  
THESE DESIGNS AND DRAWINGS ARE COPYRIGHT AND ARE NOT TO BE USED OR REPRODUCED WITHOUT THE WRITTEN PERMISSION OF VERIS

Data Sources 30109-LC-Master(DB) F504 2014.dwg  
Cadastral Boundaries  
As-on survey Veris  
Engineering Design COLLIER'S

Issue	Revisions	Date	Drawn
C	Progress Plot	12.07.2024	JMc
B	Progress Plot	29.05.2024	JMc
A	Progress Plot	02.05.2024	JMc

Local Authority: LCC  
Horizontal Meridian: MGA  
Vertical Level Datum: AHD D  
Level Origin: PM107142(RL39.078)  
Scale: 1:250 @ A1  
Surveyed: HA  
Designed: COLLIER'S  
Drawn: JMc  
Checked: JMc  
Plot Date: 17 Jul, 2024  
Computer File Ref: 430109-15061-AS01 C LOCAL.dwg

**AS-CONSTRUCTED  
SEWER**

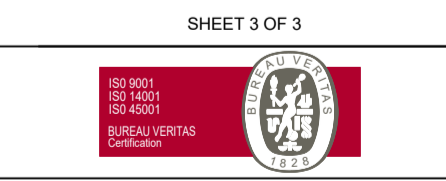

**veris**

BRISBANE (07) 3668 4700 WHITSUNDAYS (07) 4945 6800  
MACKAY (07) 4957 8700 CAIRNS (07) 4232 9400

veris.com.au  
ACN 615 735 727  
Veris Australia Pty Ltd

Drawing No 430109-15061-AS01 C Issue